

FLOORS 3 - 5

28,800 RSF

The extra-large floor plates offer seating density and promote collaboration more than most buildings in Portland. Wrapped in windows, these floors have great sightlines and tons of natural light. The 5th floor has a large skylight below the rooftop patio.

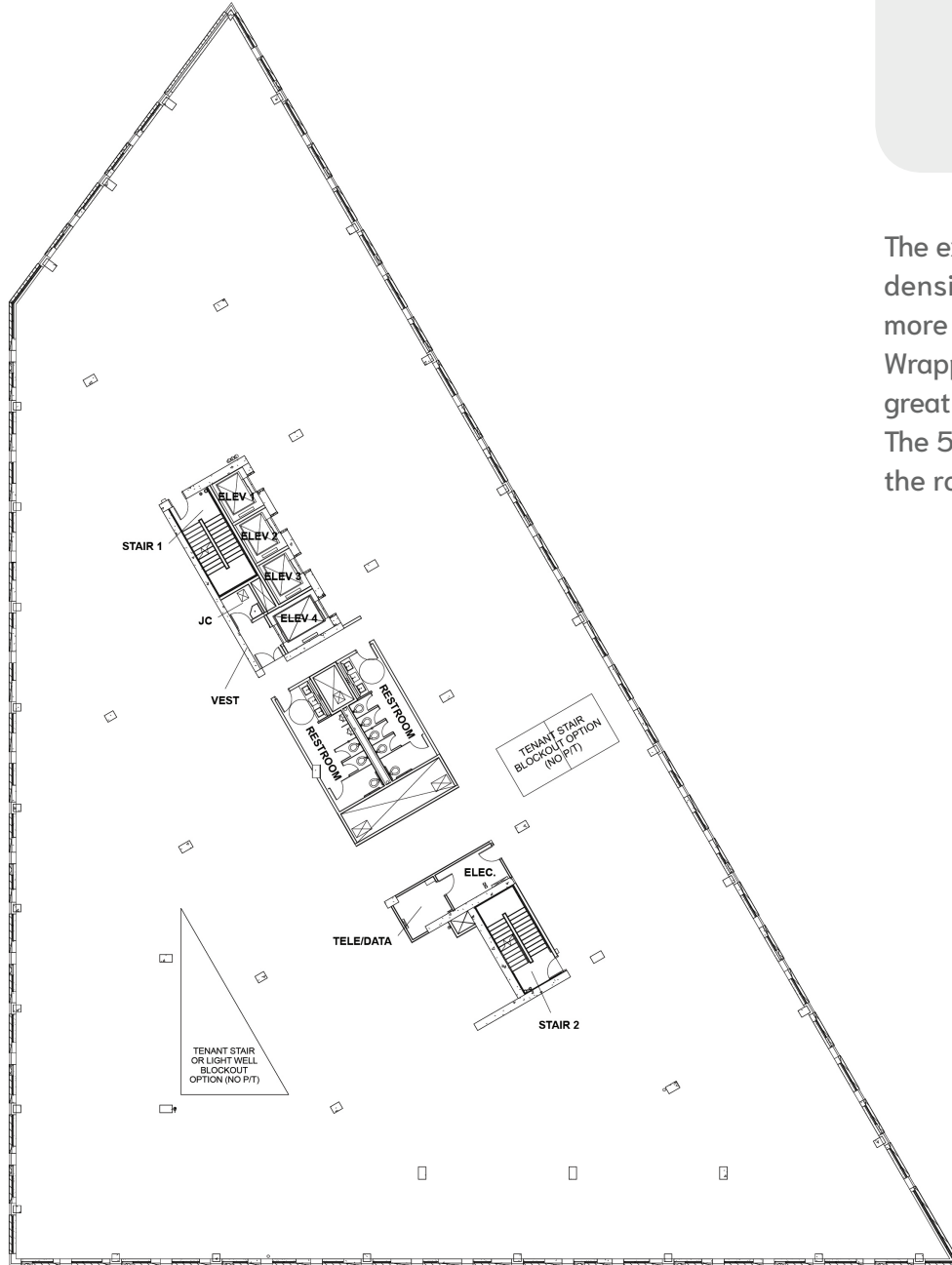

**EXPERIENCE THE
ADVANTAGE**

FOR MORE INFORMATION, CONTACT THE LEASING TEAM:

TREVOR KAFOURY

Executive Vice President
+1 503 221 4896
trevor.kafoury@cbre.com

KEVIN KAUFMAN

First Vice President
+1 503 221 4808
kevin.kaufman@cbre.com

AUTUMN BRICE

Transaction Specialist
+1 503 221 4812
autumn.brice@cbre.com

CBRE

WWW.TANNERPOINT.COM

1250 NW 9TH AVE | PORTLAND, OR 97209