

Industrial | For Sale or Lease

CBRE

Unit 115

1891 Foy Street

Abbotsford, BC

10,522 SF Modern Industrial Unit with Dock and Grade Loading
Located at Foy Street Business Centre



Unit 115 - 1891 Foy Street | Abbotsford, BC
10,522 SF Modern Industrial Unit with Dock & Grade Loading



The Opportunity

CBRE Limited is pleased to present the opportunity to purchase or lease a modern industrial unit at Foy Street Business Centre. This 10,522 SF unit features dock and grade loading, 26’ clear ceilings, fully enclosed mezzanine with forklift access, and excellent corporate appeal.

The property is located in Abbotsford’s west industrial area just off Highway #1 at the Clearbrook Road exit and is situated 5 minutes to Abbotsford International Airport, 15 minutes to the US Border crossing, and 60 minutes to Vancouver International Airport.

Area Breakdown

Warehouse	8,771 SF
Mezzanine	1,751 SF
Total	10,522 SF

*Areas are approximate.



Property Details

Unit Size

10,522 SF

Zoning

I2 (General Industrial)

Available

Immediately

Asking Sale Price

\$4,629,680 (\$440 PSF)

Asking Lease Rate

Contact Listing Agents

Additional Rent

Contact Listing Agents

Space Features

- + **Loading**
1 dock loading door and
1 grade loading door
- + **Ceiling Height**
26’ clear
- + **Electrical Service**
125 amp, 347/600-volt,
3-phase electrical service
- + **Mezzanine**
Structural steel with
100 lbs PSF floor load
capacity
- + **Sprinklers**
ESFR sprinkler system
- + **Warehouse Heating**
Gas fired, forced air
heating units
- + **Floor Load**
500 lbs PSF floor load
capacity
- + **Parking**
14 stalls

Industrial | For Sale or Lease

Floor Plan

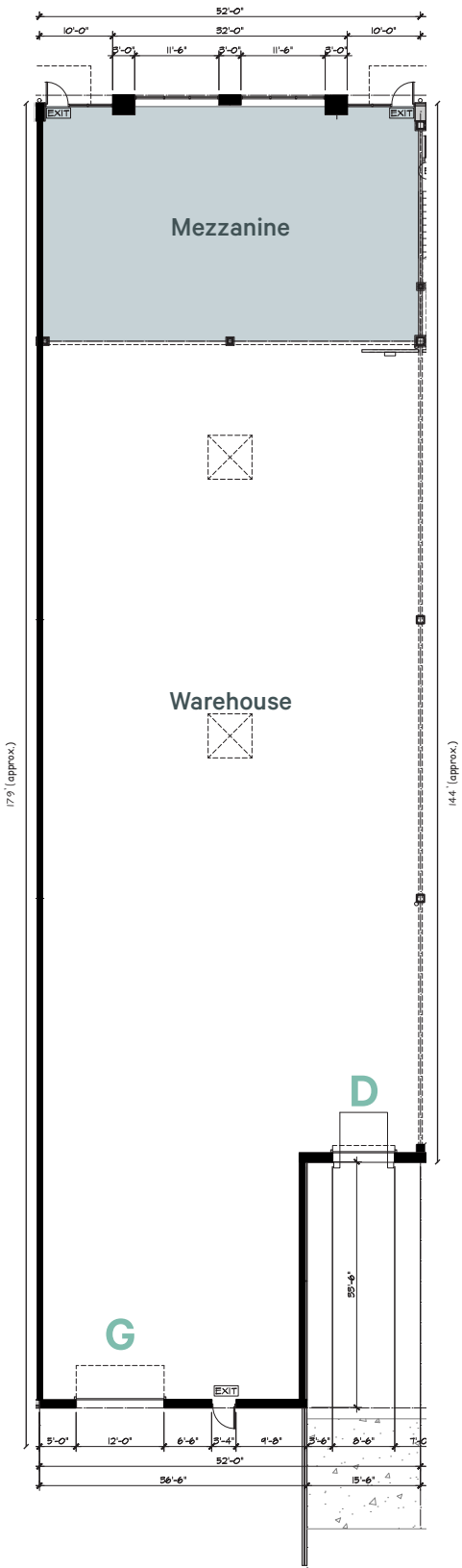

*Floor plan not to scale. Dimensions are approximate.

Unit 115 - 1891 Foy Street | Abbotsford, BC
10,522 SF Modern Industrial Unit with Dock & Grade Loading

Industrial | For Sale or Lease

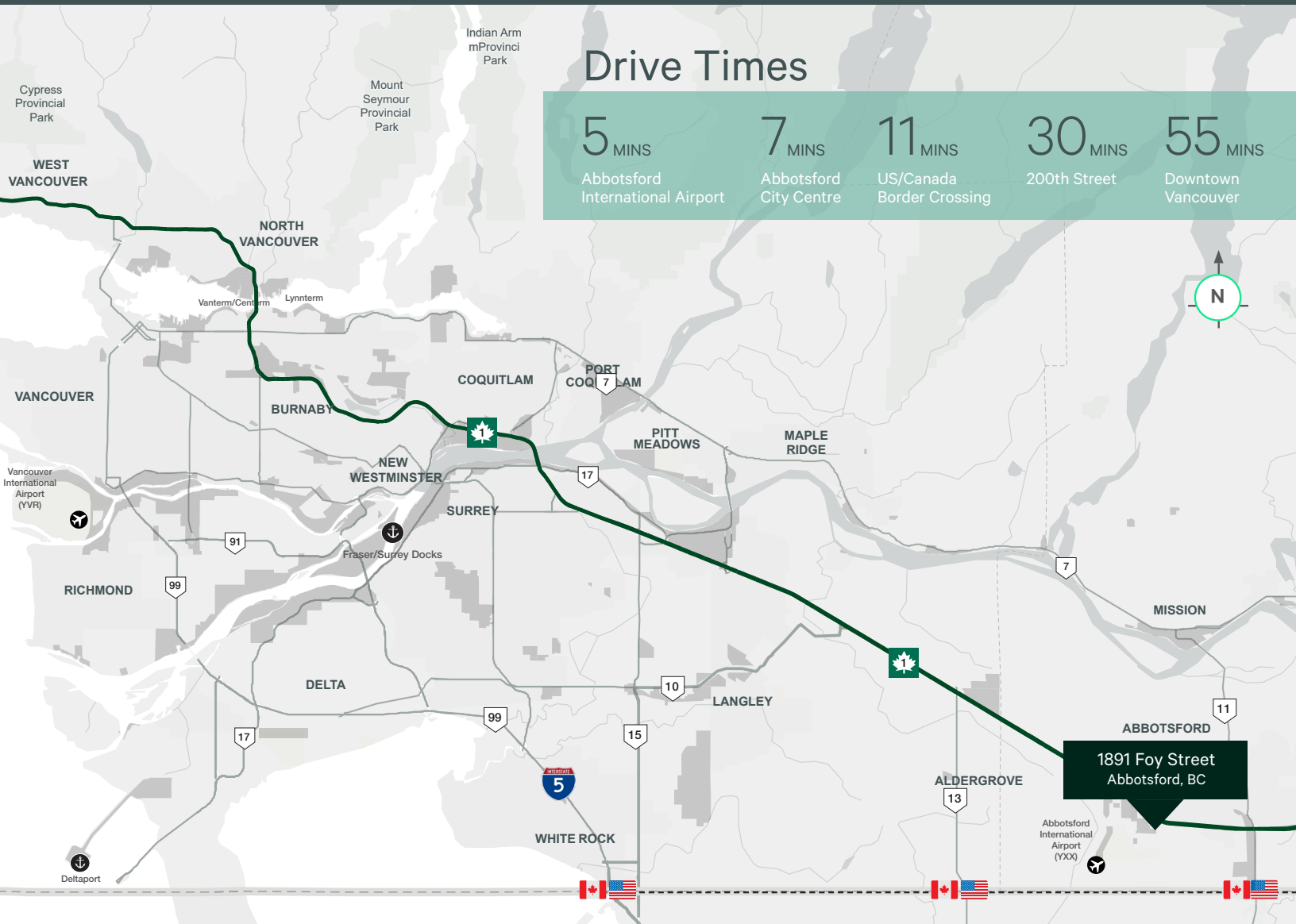

Contact

Travis Blanleil

Personal Real Estate Corporation
Vice President
Industrial Properties
+1 604 662 5100
travis.blanleil@cbre.com

Chris MacCauley

Personal Real Estate Corporation
Executive Vice President
Industrial Properties
+1 604 662 5190
chris.maccauley@cbre.com

This disclaimer shall apply to CBRE Limited, Real Estate Brokerage, and to all other divisions of the Corporation; to include all employees and independent contractors ("CBRE"). The information set out herein, including, without limitation, any projections, images, opinions, assumptions and estimates obtained from third parties (the "Information") has not been verified by CBRE, and CBRE does not represent, warrant or guarantee the accuracy, correctness and completeness of the Information. CBRE does not accept or assume any responsibility or liability, direct or consequential, for the Information or the recipient's reliance upon the Information. The recipient of the Information should take such steps as the recipient may deem necessary to verify the Information prior to placing any reliance upon the Information. The Information may change and any property described in the Information may be withdrawn from the market at any time without notice or obligation to the recipient from CBRE. CBRE and the CBRE logo are the service marks of CBRE Limited and/or its affiliated or related companies in other countries. All other marks displayed on this document are the property of their respective owners. All Rights Reserved.

Mapping Sources: Canadian Mapping Services canadamapping@cbre.com; DMTI Spatial, Environics Analytics, Microsoft Bing, Google Earth.

www.cbre.ca/properties

CBRE