

FOR SALE

# 18,500 SF HANGAR FACILITY AT PAINE FIELD



10719 BERNIE WEBBER DRIVE | MUKILTEO, WA 98275

**CBRE**

# FOR SALE : \$5.75 MILLION

CBRE is pleased to offer this exceptional opportunity to purchase a premier aircraft hangar at Paine Field. The facility was built in 2007 to house a historic aircraft museum and has high-end, custom features. It is in pristine condition and offers a state-of-the-art venue for a variety of aviation-related uses including private aircraft storage, maintenance, charter, and FBO operations. The facility can also be easily partitioned into two separate hangar bays. The Seattle-area hangar market has become exceptionally tight in recent years. This is a rare opportunity to own a premier facility.



## HIGHLIGHTS



14,500 SF hangar bay with polished concrete floor



Two side-by-side tilt-up hangar doors each approximately 23.5 ft. tall by 72 ft. wide



4,000 SF of high-end office, restrooms, kitchenette, conference areas



Excellent light and heat, insulated throughout



Parking area with spaces for 21 cars



Ample ramp area



Ground lease term through May 17, 2057 (including 10-year extension option)



Prime location in private area in southwest quadrant of Paine Field

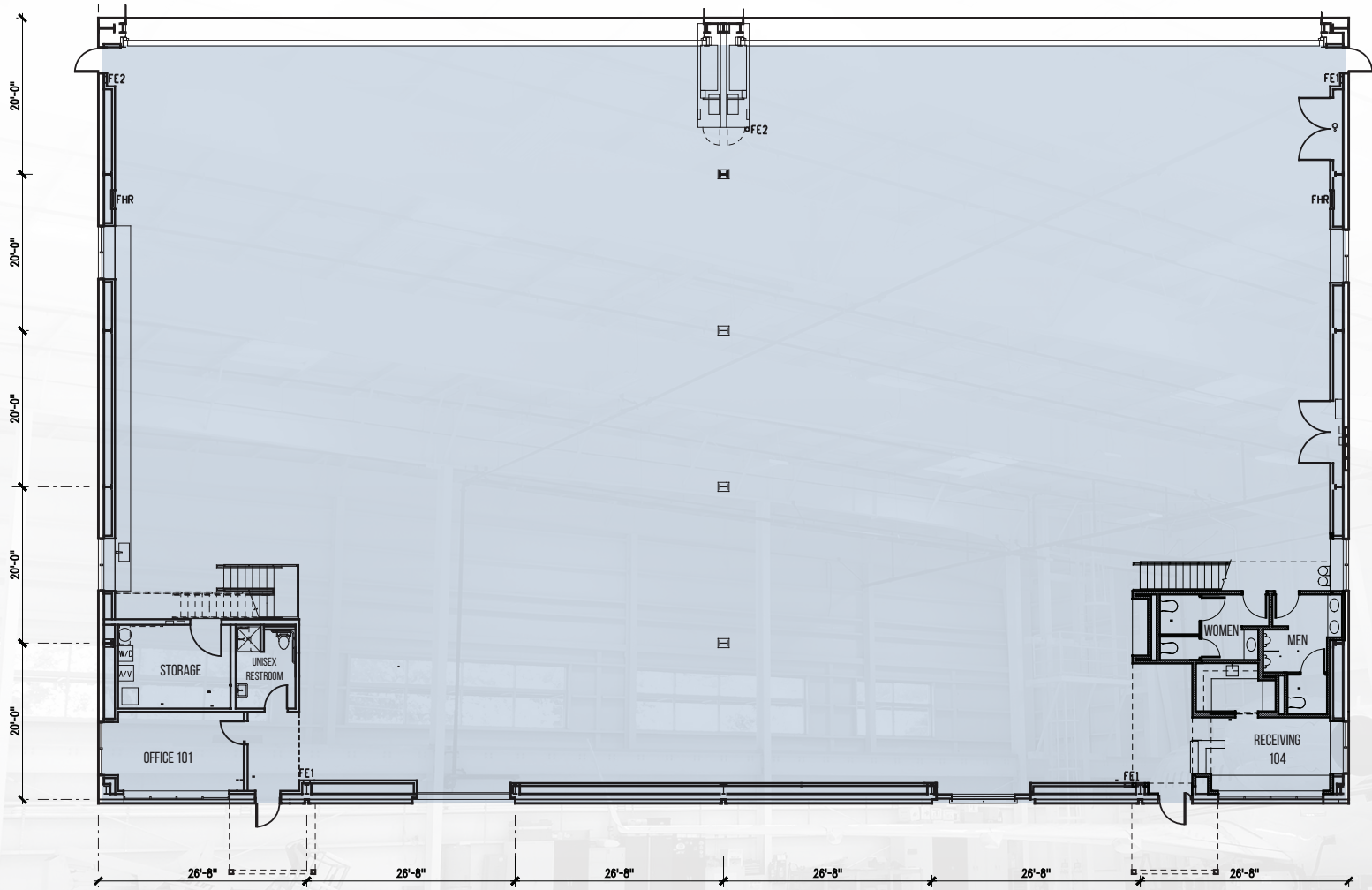

# FLOOR PLAN

# PROPERTY PHOTOS





ELECTROIMPACT

**18,500 SF HANGAR  
FACILITY AT PAINE FIELD  
10719 BERNIE WEBBER DRIVE**

PAINE FIELD BLVD

MUKILTEO SPEEDWAY

**BOEING**  
EMC

FLYING HERITAGE  
& COMBAT ARMOR  
MUSEUM

COMMERCIAL PASSENGER  
TERMINAL  
(Alaska and United  
Airlines)

**BOEING**  
DELIVERY

COLLINS  
AEROSPACE

ESTERLINE CONTROL  
SYSTEMS - KORRY

AVIATION  
TECHNICAL SERVICES  
(4 LOCATIONS)

AVIATION  
TECHNICAL SERVICES  
(4 LOCATIONS)

PAINE FIELD  
ADMINISTRATION  
OFFICE

VAUPELL  
ENGINEERING

PAINE FIELD  
BUSINESS OFFICE

WASHINGTON  
AEROSPACE  
TRAINING &  
RESEARCH  
CENTER (WATR)

BEVERLY PARK ROAD

**BOEING**

COLLINS  
AEROSPACE

SNO-ISLE  
TECH SCHOOL

AVIATION  
TECHNICAL SERVICES  
(4 LOCATIONS)

CADENCE  
AEROSPACE

COLLINS  
AEROSPACE



AIRPORT ROAD

XPO LOGISTICS

COMMUNITY  
TRANSIT



# PAINE FIELD

Located in Everett, Washington, Paine Field/Snohomish County Airport is home to over 550 aircraft including single engine recreational aircraft, corporate jets, vintage warbirds and Boeing. The airport offers high quality aviation facilities including an FAA tower, a 9,010 ft. runway, Cat 1 ILS, Part 139 certification, FBO services and convenient access to Seattle, Bellevue and Redmond.

Paine Field now offers commercial aircraft service to several destinations throughout the United States, through a brand new commercial passenger terminal.



# CONTACT INFORMATION

---

## **KATRIN M. GIST**

First Vice President  
National Lead,  
CBRE Airport Properties  
+1 206 947 1399  
katrin.gist@cbre.com

## **CBRE, INC**

1420 5th Avenue  
Suite 1700  
Seattle, WA 98101

© 2020 CBRE, Inc. All rights reserved. This information has been obtained from sources believed reliable, but has not been verified for accuracy or completeness. You should conduct a careful, independent investigation of the property and verify all information. Any reliance on this information is solely at your own risk. CBRE and the CBRE logo are service marks of CBRE, Inc. All other marks displayed on this document are the property of their respective owners. Photos herein are the property of their respective owners. Use of these images without the express written consent of the owner is prohibited. PMStudio\_March2020

**CBRE**