

6TH FLOOR WITH DECK

22,600 RSF

Featuring the same open collaborative concept and natural light, the 6th floor offers a smaller floor plate and direct access to an outdoor patio that looks back at the Pearl District and Downtown skyline.

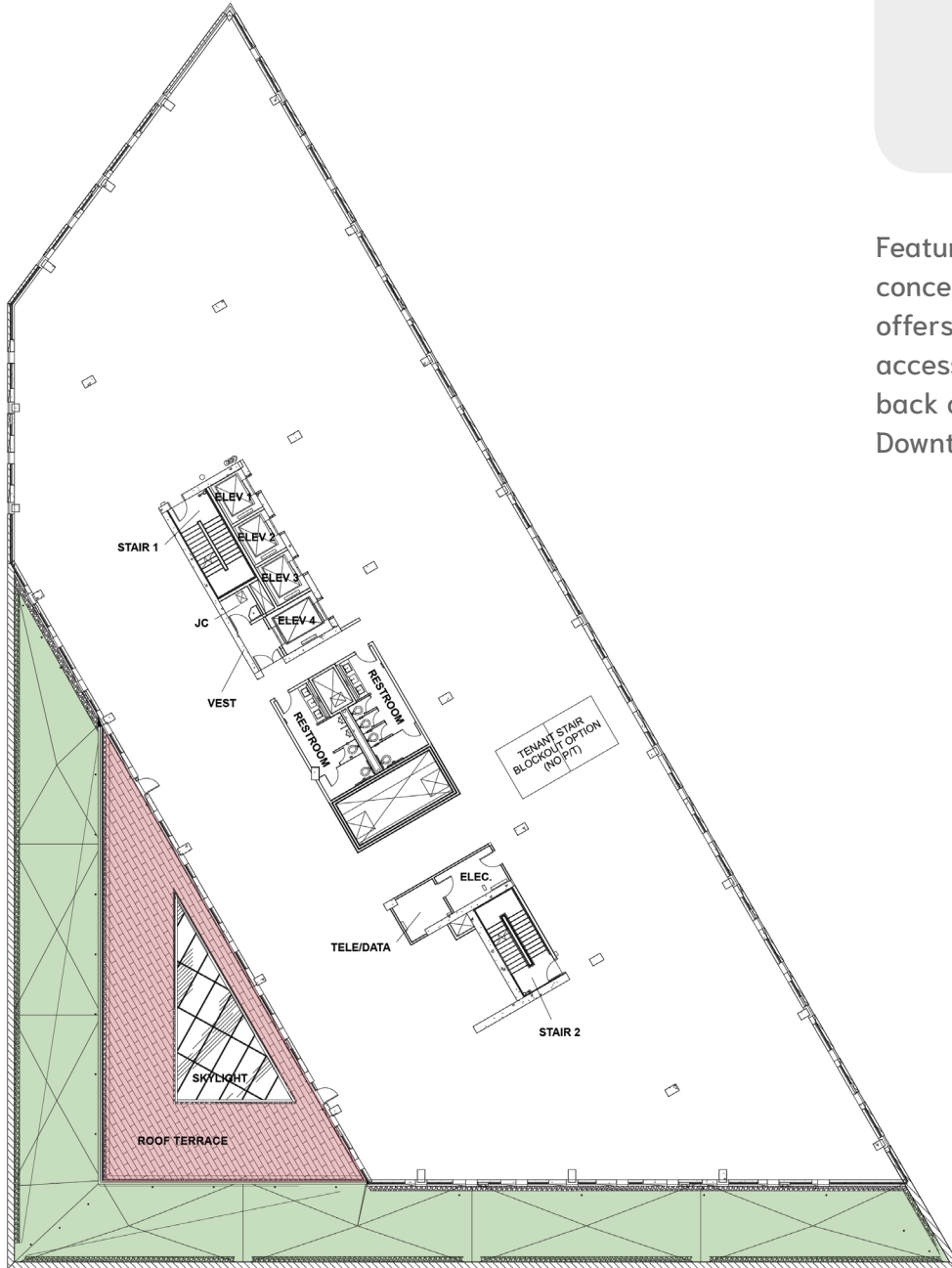

EXPERIENCE THE
ADVANTAGE

FOR MORE INFORMATION, CONTACT THE LEASING TEAM:

TREVOR KAFOURY
Executive Vice President
+1 503 221 4896
trevor.kafoury@cbre.com

KEVIN KAUFMAN
First Vice President
+1 503 221 4808
kevin.kaufman@cbre.com

AUTUMN BRICE
Transaction Specialist
+1 503 221 4812
autumn.brice@cbre.com

CBRE

WWW.TANNERPOINT.COM

1250 NW 9TH AVE | PORTLAND, OR 97209