

THE MACON

AT EDWARDS MILL

RALEIGH'S NEWEST MEDICAL OUTPATIENT AND R&D LAB DEVELOPMENT
NEWLY DELIVERED AND READY FOR TENANT UPFITS!

CBRE

4225 Macon Pond Road at Edwards Mill Road • Raleigh, NC 27607

±120,694 RSF, 4-STORY, CLASS A, STATE-OF- THE-ART MEDICAL OUTPATIENT AND R&D LAB BUILDING

- Highly visible signage on Edwards Mill Road, overlooking the entrance to the UNC Rex campus
- Forward-thinking high-tech exterior facade to compliment surrounding area from all floors
- Exterior façade features intricate concrete and aluminum paneling with stone accents
- Building design keeps environmentally friendly options in the forefront, including energy efficient mechanical systems and sustainability materials
- 4-story concrete parking deck with 539 spaces and surface parking, providing a 5:1,000 ratio

NEWLY DELIVERED AND READY FOR TENANT UPFITS!



AVAILABLE SPACE

1ST FLOOR

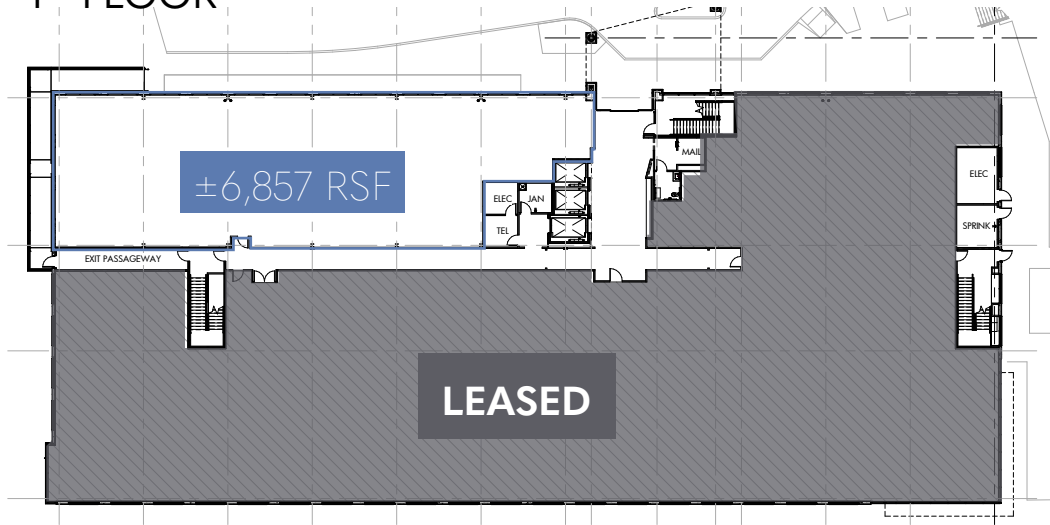

2ND FLOOR

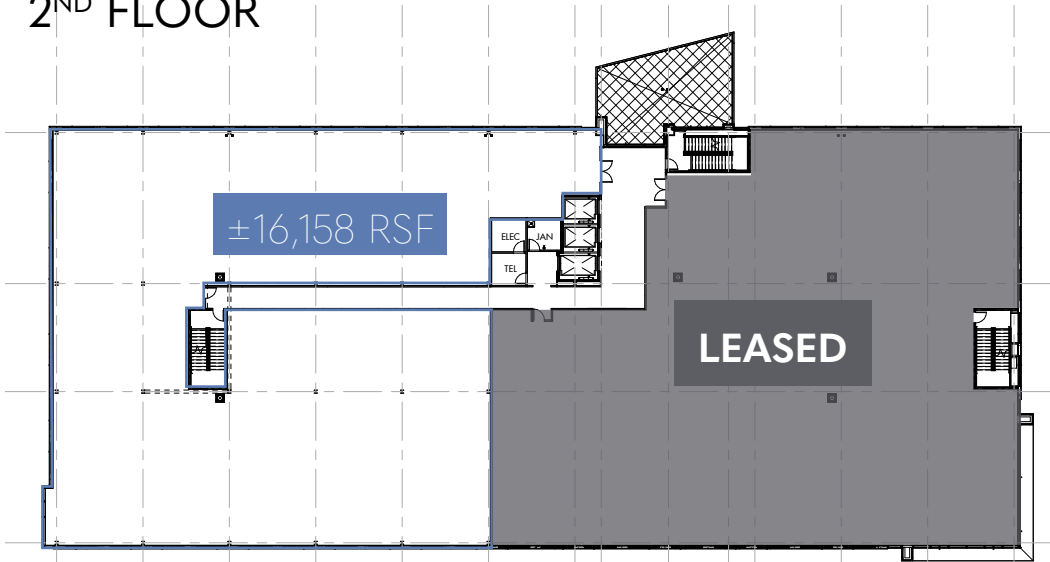

LARGE, EFFICIENT FLOOR PLATES

COLUMN SPACING: 24' x 30'



AVAILABLE SPACE

3RD FLOOR

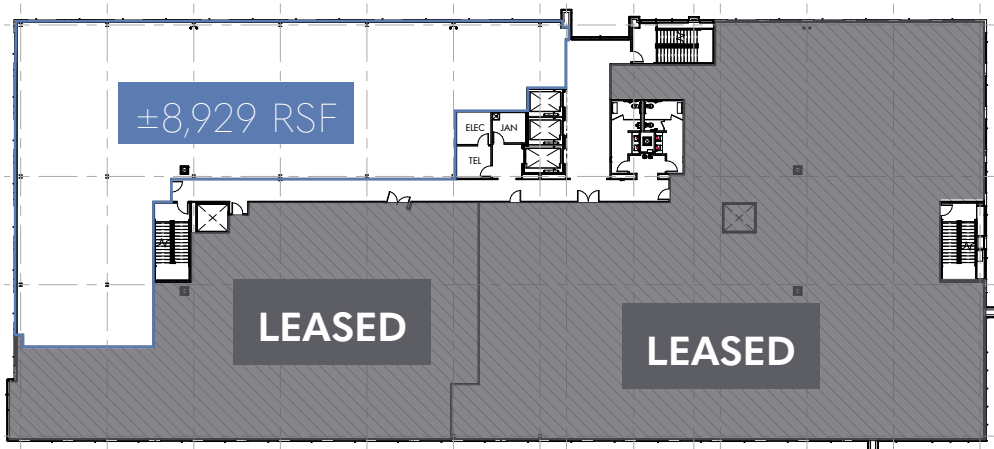

4TH FLOOR | FULL FLOOR AVAILABLE

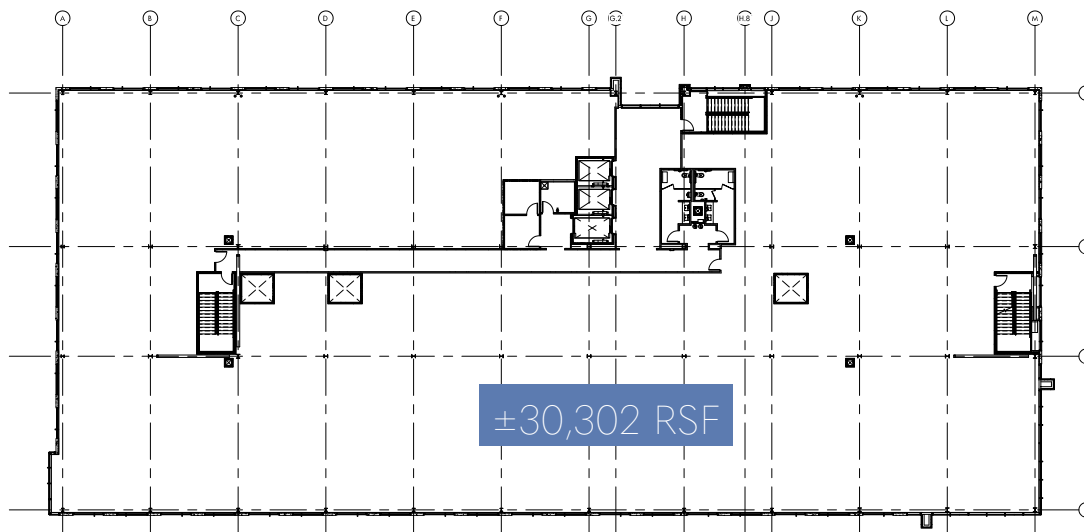

LARGE, EFFICIENT FLOOR PLATES

COLUMN SPACING: 24' x 30'



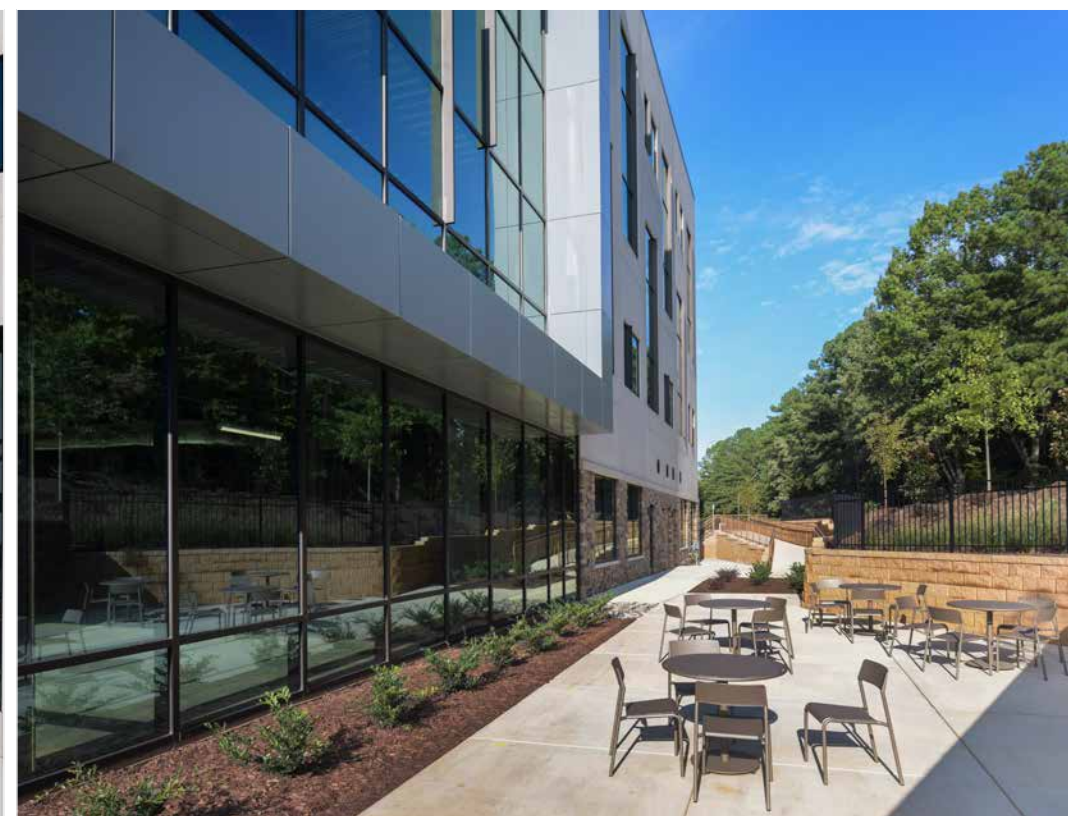

The Macon at Edwards Mill

SITE PLAN



- Expansive views of Macon Pond and preserved state-owned land.
- Building is situated at a higher elevation providing views of surrounding area from all floors, including the UNC Rex Hospital campus .
- Signage opportunity prominently located directly across from the NC Rex Hospital Campus off I-40 and Edwards Mill.
- Site is the last remaining property in the submarket between preserved NC State agricultural research land and the expanding Rex Hospital campus. This unique location allows for a perfect mix of nature and convenience.

NORTH HILLS

UNC REX CANCER CENTER EXPANSION
PHASE I NOW OPEN - [MORE DETAILS](#)



EDWARDS MILL ROAD

MACON POND ROAD

ADJACENT TO THE RAPIDLY
GROWING UNC REX
HEALTHCARE CAMPUS

WHY RALEIGH?

#1

**BEST PLACE TO
LIVE IN 2022**

Bankrate | June 2022

#2

**LARGE METRO WHERE
WAGES ARE RISING THE
FASTEST**

Smartest Dollar |
August 2022

#5

**BEST LARGE AIRPORT
IN AMERICA (RDU
INTERNATIONAL
AIRPORT)**

J.D. Power |
September 2022

#1

**TOP CITY WITH THE
MOST RESILIENT
ECONOMIES IN THE U.S.**

SmartAsset | July 2022

#2

**TOP METRO WITH
HIGHEST AVERAGE
UNIVERSITY QUALITY**

WalletHub | July 2022

#4

**TOP BIOPHARMA
LEADERS IN
AMERICA**

Business
Facilities | August 2022

#1

**TOP METRO WITH
HIGHEST % OF
GRADUATE OR
PROFESSIONAL DEGREES**

WalletHub | July 2022

#4

**TOP GLOBAL
BIOTECH HUB**

Hickey & Assoc. | August
2022

#3

**HOTTEST JOB
MARKET IN AMERICA**

WSJ & Moody's | April 2022

THE MACON

AT EDWARDS MILL

For more information:

CBRE

ED PULLIAM

Executive Vice President
ed.pulliam@cbre.com
+1 919 831 8237

LEE CLYBURN, SIOR

Executive Vice President
lee.clyburn@cbre.com
+1 919 831 8266

A development by:



© 2025 CBRE, Inc. All rights reserved. This information has been obtained from sources believed reliable but has not been verified for accuracy or completeness. CBRE, Inc. makes no guarantee, representation or warranty and accepts no responsibility or liability as to the accuracy, completeness, or reliability of the information contained herein. You should conduct a careful, independent investigation of the property and verify all information. Any reliance on this information is solely at your own risk. CBRE and the CBRE logo are service marks of CBRE, Inc. All other marks displayed on this document are the property of their respective owners, and the use of such marks does not imply any affiliation with or endorsement of CBRE.