

# THREE BALA PLAZA EAST

# NEWMARK

SUITE 400 - 28,545 RSF

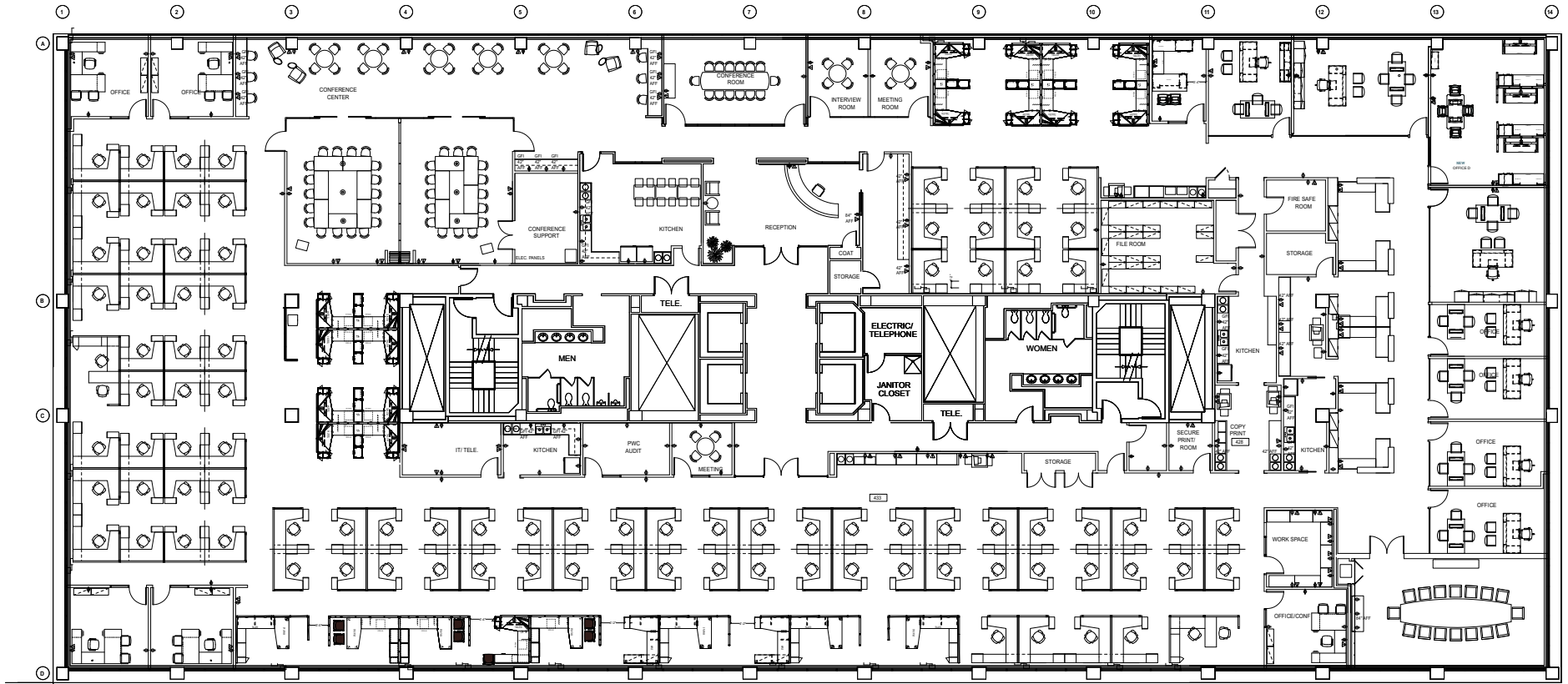

**CHRIS LANGE**  
Executive Managing Director  
t 610-331-8021  
chris.lange@nmrk.com

**JEFFREY E. MACK**  
Executive Managing Director  
t 610-755-6960  
jeff.mack@nmrk.com

**MIKE O'NEILL**  
Associate  
t 610-603-6867  
mike.oneill@nmrk.com

1000 Continental Drive  
Suite 200  
King of Prussia, PA 19406  
610-265-0600 | [nmrk.com](http://nmrk.com)

# THREE BALA PLAZA EAST

# NEWMARK

SUITE 500 - 5,742 RSF

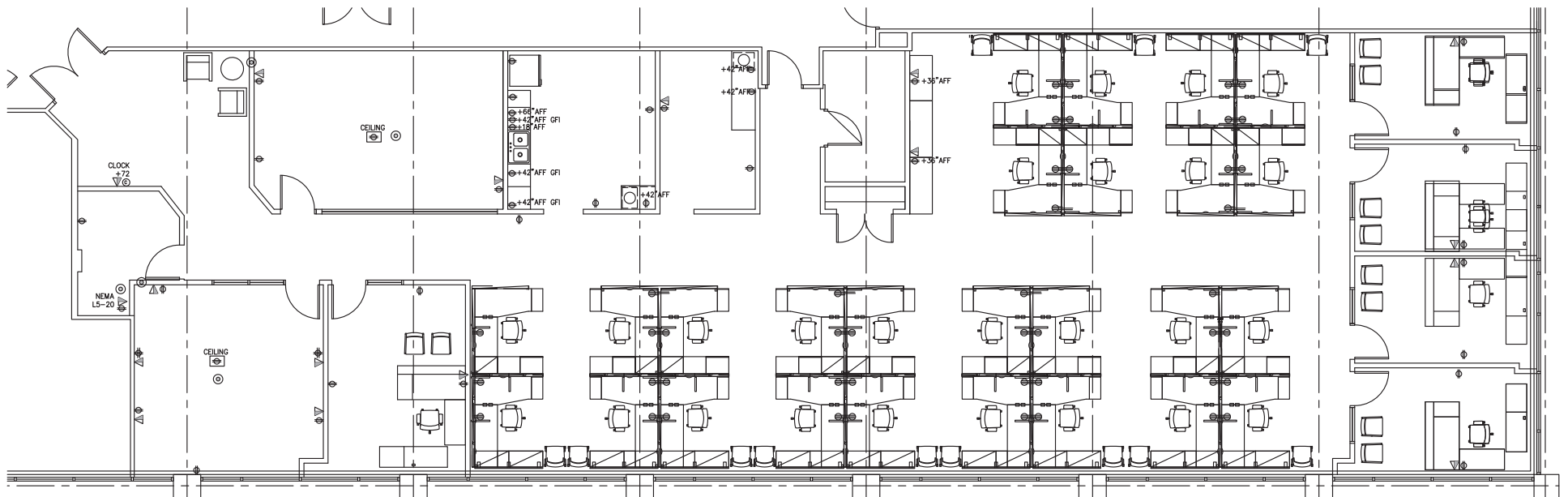

**CHRIS LANGE**  
Executive Managing Director  
t 610-331-8021  
chris.lange@nmrk.com

**JEFFREY E. MACK**  
Executive Managing Director  
t 610-755-6960  
jeff.mack@nmrk.com

**MIKE O'NEILL**  
Associate  
t 610-603-6867  
mike.oneill@nmrk.com

1000 Continental Drive  
Suite 200  
King of Prussia, PA 19406  
610-265-0600 | [nmrk.com](http://nmrk.com)

LICENSED IN PENNSYLVANIA AS NEWMARK REAL ESTATE. The information contained herein has been obtained from sources deemed reliable but has not been verified and no guarantee, warranty or representation, either express or implied, is made with respect to such information. Terms of sale or lease and availability are subject to change or withdrawal without notice.

# THREE BALA PLAZA WEST

# NEWMARK

SUITE 701 – 15,023 RSF



**CHRIS LANGE**  
Executive Managing Director  
t 610-331-8021  
chris.lange@nmrk.com

**JEFFREY E. MACK**  
Executive Managing Director  
t 610-755-6960  
jeff.mack@nmrk.com

**MIKE O'NEILL**  
Associate  
t 610-603-6867  
mike.oneill@nmrk.com

1000 Continental Drive  
Suite 200  
King of Prussia, PA 19406  
610-265-0600 | [nmrk.com](http://nmrk.com)

LICENSED IN PENNSYLVANIA AS NEWMARK REAL ESTATE. The information contained herein has been obtained from sources deemed reliable but has not been verified and no guarantee, warranty or representation, either express or implied, is made with respect to such information. Terms of sale or lease and availability are subject to change or withdrawal without notice.