

Winsford Industrial Estate PremierPark

Junction 18 & 19 M6 Winsford

 CW7 3PH

TO LET Unit 4
Industrial Warehouse Unit
10,120 sq ft
(939.76 sq m)



Winsford Industrial Estate PremierPark

Junction 18 & 19 M6 Winsford

CW7 3PH

Location

Premier Park fronts Road One of the Winsford Industrial Estate. The southern end of Road One links with the A54 Middlewich Road, which in turn provides access to the M6 motorway at junction 18.

Alternatively, at the northern end of Road One, the A533 provides access to the A556 Northwich by-pass which links to junction 19 of the M6 motorway.

- Located 25 minutes from Manchester Airport
- Regional rail freight terminals are situated in Liverpool and Manchester.

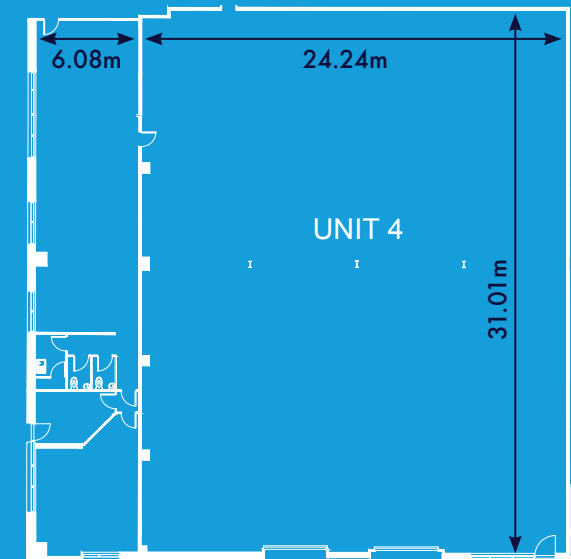

Description

The premises are constructed using a steel frame and clad in a high quality Hoesch panel system with insulated and fully lined elevations and ceilings.

Specification

- High quality cladding system
- Extensive car parking
- Individual entrance / loading areas
- Secure site
- Multiple unit size options available
- 30Kn per sq m floor loading
- Office content and WC facilities
- Flexible terms
- 3.4m clear eaves height
- Good access to J18 M6 motorway.



Accommodation

The premises have been measured on a Gross Internal Area Basis in accordance with the RICS Code of Measuring Practice (6th edition) and comprise the following:

UNIT	m ²	ft ²
GF OFFICES	188.54	2029.43
WAREHOUSE	751.22	8091.02
TOTAL	939.76	10,120.45

Contacts

For further information / viewings please contact:

Paul Cook
t: 0161 233 5619
m: 07793 119 221
e: paul.j.cook@cbre.com

Mathew Pochin
t: 01270 621005
m: 07831 445 009
e: mattpochin@legatowen.co.uk

