

**±36,200 SF AIRCRAFT HANGAR
AND OFFICE FACILITY FOR SALE
AT MANASSAS REGIONAL AIRPORT**

10761 JAMES PAYNE COURT
Manassas, Virginia 20110



FOR SALE: \$7.95 MILLION

CBRE

THE OPPORTUNITY

CBRE is pleased to offer a ±36,200 SF aircraft hangar and office facility for sale at Manassas Regional Airport (also known as Harry P. Davis Field) in Manassas, Virginia. The facility consists of a ±26,200 SF hangar bay, plus approximately 10,000 SF of high-end office/lobby/shop area, including conference rooms, private offices, pilot and passenger lounges, and kitchen and galley areas. This is an excellent opportunity to secure a large private hangar in the Capital Region, and would be an ideal fit for a wide variety of aviation venues. This location is an excellent alternative to Dulles International Airport. The I66 Express lanes project is scheduled to become fully operational by the end of 2022, which will make Manassas Regional Airport an even faster location to reach. With no airline congestion to compete with, coupled with the new I66 Express lanes, operating out of Manassas will often be a quicker option to get off the ground than Dulles.

HIGHLIGHTS

- » ±26,200 SF hangar bay
- » ± 10,000 SF of high-end office/lobby/shop area, including conference rooms, private offices, pilot and passenger lounges, and kitchen and galley areas
- » Hangar door dimensions: 28' height x +/- 134' width
- » Built in 2007
- » Ground lease through October 31, 2045
- » Enhanced overhead lighting
- » Hangar doors include windows for additional light
- » Ample parking area with ±46 parking spaces
- » Roll-up doors on each side of the hangar bay
- » Ample ramp space
- » Parcel size: 2.1 acres
- » High gloss epoxy floor



FLOOR PLAN

Air Operations Area - Ramp

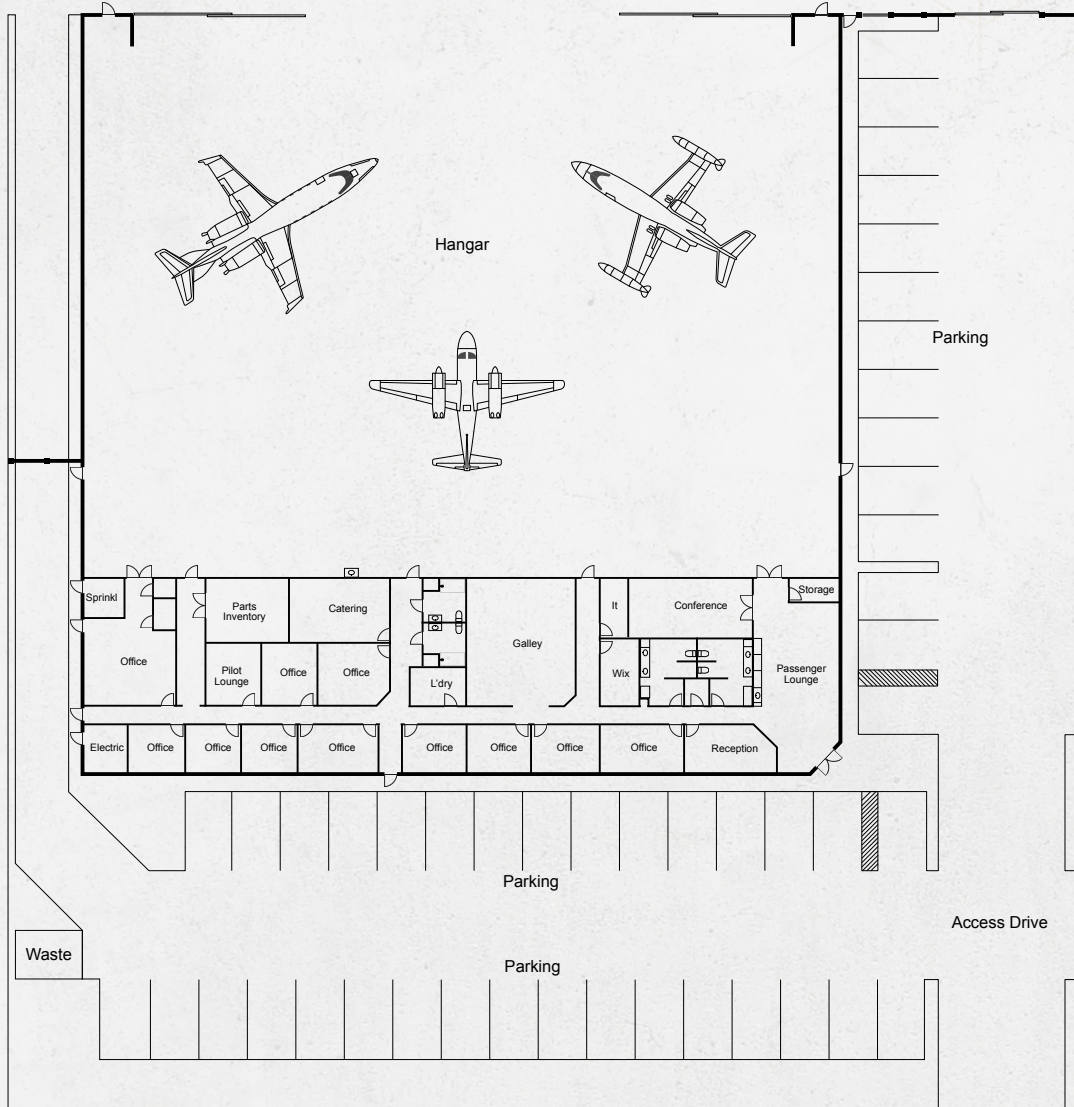
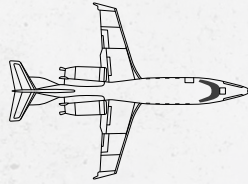

JAMES PAYNE COURT





MANASSAS REGIONAL AIRPORT (HARRY P. DAVIS FIELD)

Located just thirty miles from Washington D.C., the Manassas Regional Airport is the largest regional airport in Virginia and is a convenient choice for general aviation operations. The airport covers 888 acres, and has two asphalt runways, the longest of which is 6,200 feet.



10761 JAMES PAYNE COURT

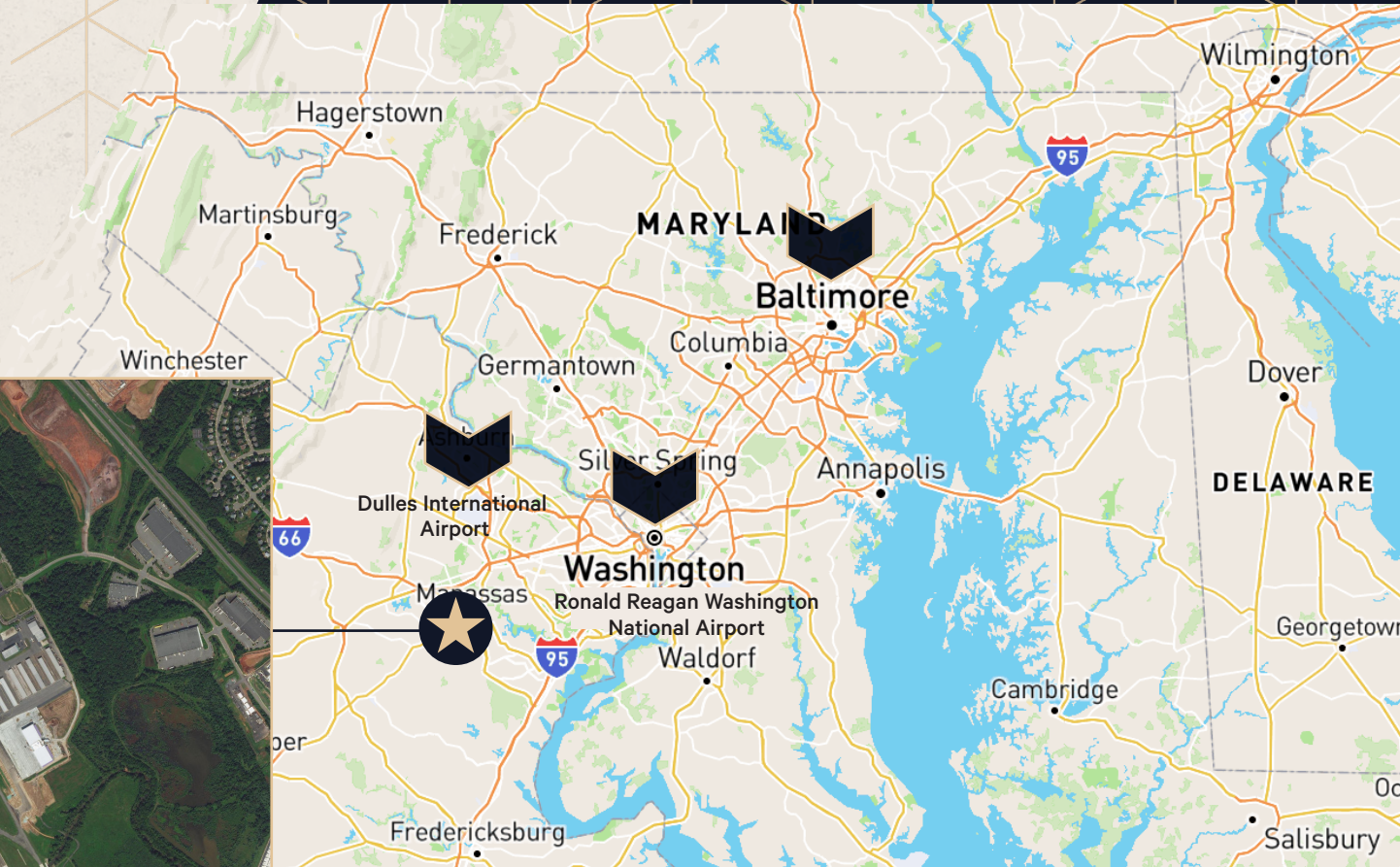

DISTANCE

Dulles International Airport - **20 Miles**

Ronald Reagan Washington National Airport - **40 Miles**

Washington D.C. - **40 Miles**

Baltimore - **78 Miles**

Richmond - **96 Miles**



10761 JAMES PAYNE COURT

Manassas, Virginia 20110

CONTACTS

KATRIN M. GIST

First Vice President

National Lead, CBRE Airport Properties

+1 206 947 1399

katrin.gist@cbre.com

TONY RUSSO

Executive Vice President

+1 703 905 0210

tony.russo@cbre.com

CBRE OFFICE

1861 International Dr, Suite 300, McLean, VA 22102

©2022 CBRE, Inc. All rights reserved. This information has been obtained from sources believed reliable but has not been verified for accuracy or completeness. You should conduct a careful, independent investigation of the property and verify all information. Any reliance on this information is solely at your own risk. CBRE and the CBRE logo are service marks of CBRE, Inc. All other marks displayed on this document are the property of their respective owners, and the use of such logos does not imply any affiliation with or endorsement of CBRE. Photos herein are the property of their respective owners. Use of these images without the express written consent of the owner is prohibited.

CBRE