

ONE BELLEVUE

411 108TH AVENUE NE, BELLEVUE, WA

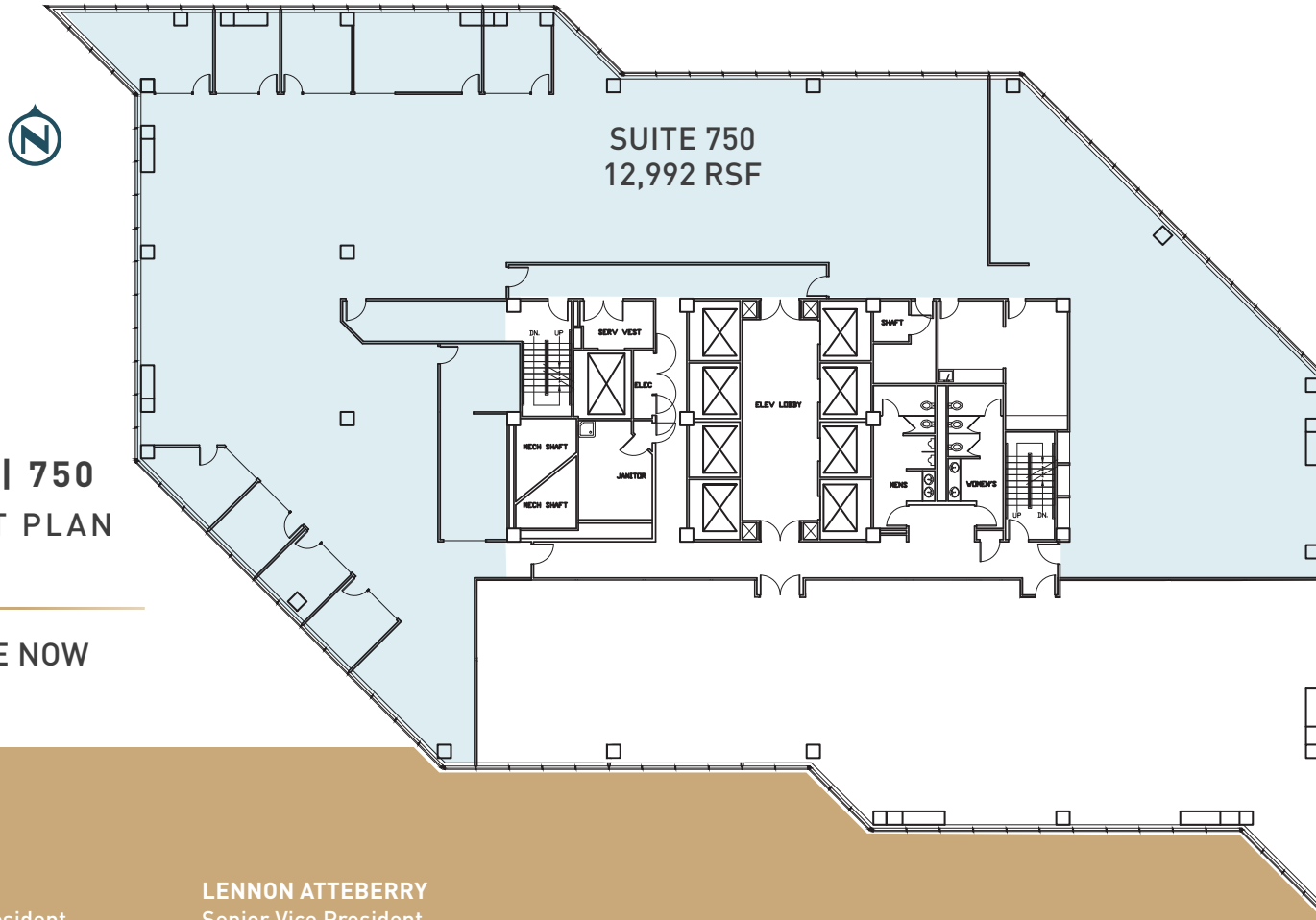

FLOOR 7
SUITES | 750
AS-BUILT PLAN

AVAILABLE NOW

SUITE 750
VIRTUAL TOUR

TIM OWENS
Senior Vice President
+1 425 462 6913
tim.owens@cbre.com

LENNON ATTEBERRY
Senior Vice President
+1 425 941 7633
lennon.attedberry@cbre.com

LaSalle™ CBRE

© 2026 CBRE, Inc. All rights reserved. This information has been obtained from sources believed reliable, but has not been verified for accuracy or completeness. You should conduct a careful, independent investigation of the property and verify all information. Any reliance on this information is solely at your own risk. CBRE and the CBRE logo are service marks of CBRE, Inc. All other marks displayed on this document are the property of their respective owners, and the use of such logos does not imply any affiliation with or endorsement of CBRE. Photos herein are the property of their respective owners. Use of these images without the express written consent of the owner is prohibited. BSO_2.9.26

ONE BELLEVUE

411 108TH AVENUE NE, BELLEVUE, WA

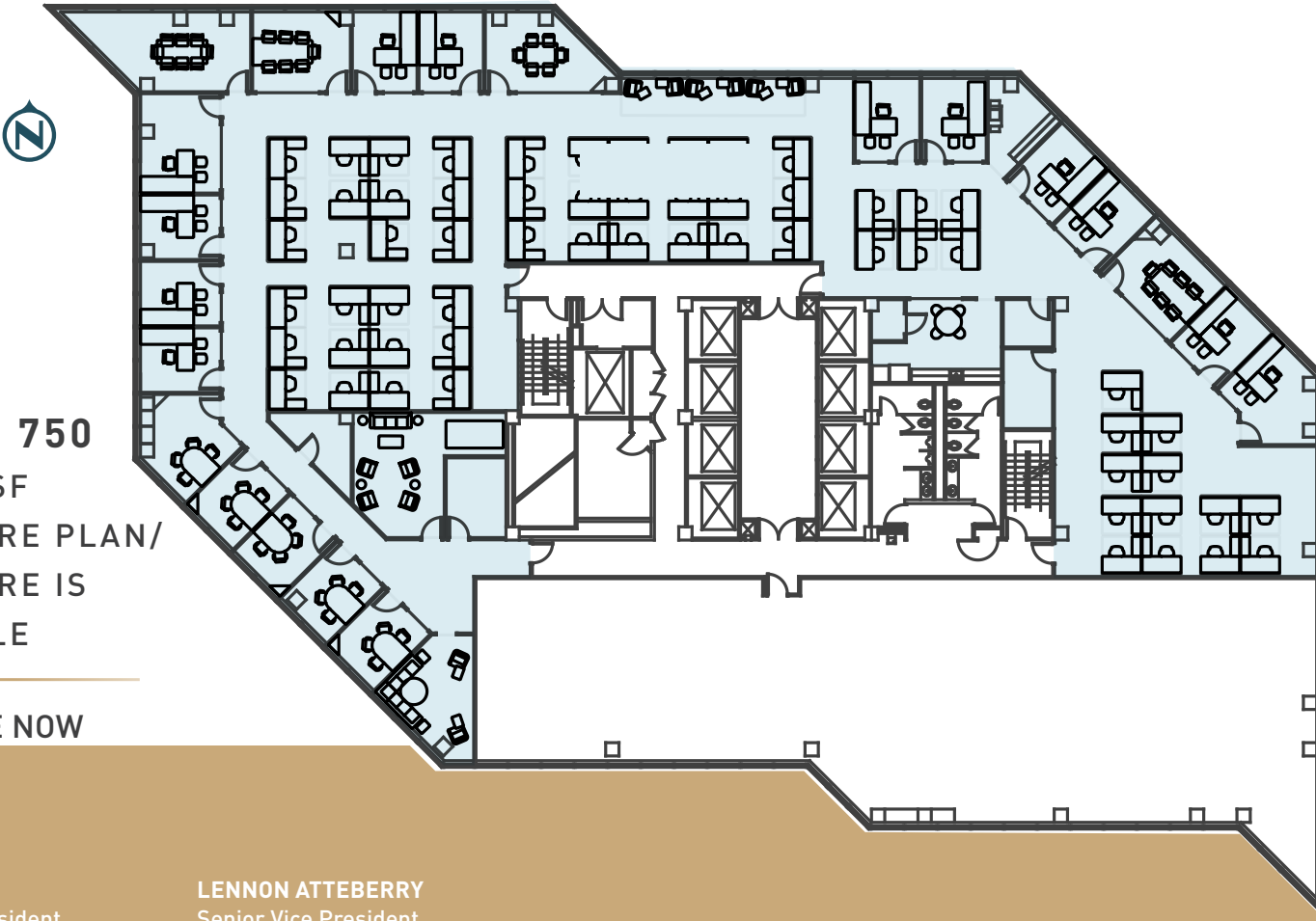

FLOOR 7

SUITE | 750

12,992 RSF

FURNITURE PLAN/
FURNITURE IS
AVAILABLE

AVAILABLE NOW

SUITE 750
VIRTUAL TOUR 

TIM OWENS
Senior Vice President
+1 425 462 6913
tim.owens@cbre.com

LENNON ATTEBERRY
Senior Vice President
+1 425 941 7633
lennon.attedberry@cbre.com

 LaSalle™ **CBRE**

© 2026 CBRE, Inc. All rights reserved. This information has been obtained from sources believed reliable, but has not been verified for accuracy or completeness. You should conduct a careful, independent investigation of the property and verify all information. Any reliance on this information is solely at your own risk. CBRE and the CBRE logo are service marks of CBRE, Inc. All other marks displayed on this document are the property of their respective owners, and the use of such logos does not imply any affiliation with or endorsement of CBRE. Photos herein are the property of their respective owners. Use of these images without the express written consent of the owner is prohibited. BSO_2.9.26