

# 2<sup>ND</sup> FLOOR

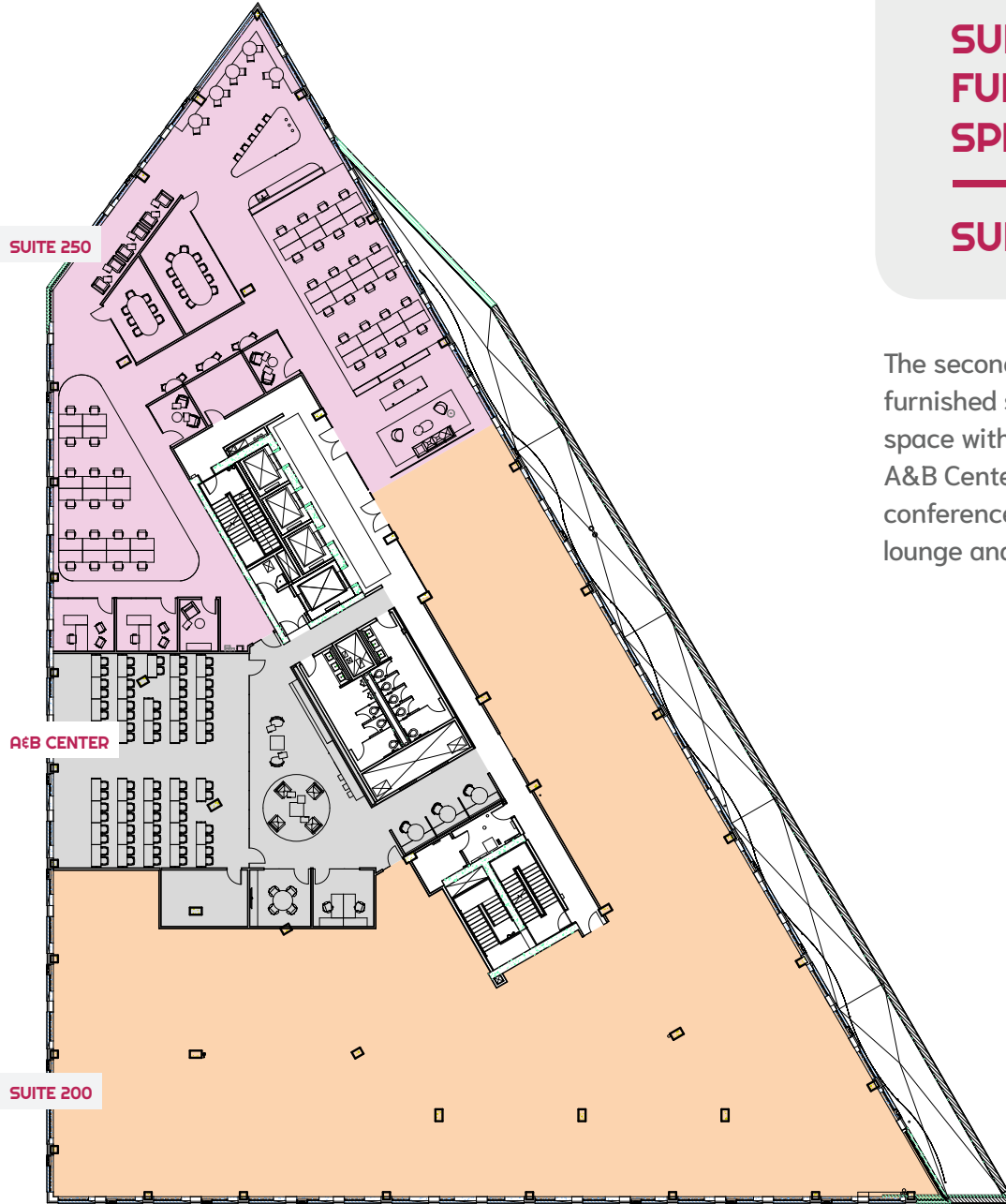

**SUITE 250:  
FULLY FURNISHED  
SPEC SUITE - 7,835 RSF**

**SUITE 200 - 16,438 RSF**

The second floor comprises a fully furnished spec suite, a large open-plan space with great sightlines and the A&B Center featuring a large conference room, comfortable lounge and private rooms.

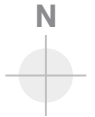

**EXPERIENCE THE  
ADVANTAGE**

FOR MORE INFORMATION, CONTACT THE LEASING TEAM:

**TREVOR KAFOURY**  
Executive Vice President  
+1 503 221 4896  
trevor.kafoury@cbre.com

**KEVIN KAUFMAN**  
First Vice President  
+1 503 221 4808  
kevin.kaufman@cbre.com

**AUTUMN BRICE**  
Transaction Specialist  
+1 503 221 4812  
autumn.brice@cbre.com

**CBRE**

[WWW.TANNERPOINT.COM](http://WWW.TANNERPOINT.COM)

1250 NW 9<sup>TH</sup> AVE | PORTLAND, OR 97209