

# 200 Allegheny Drive

Last Suite Available!

Warrendale, PA 15086  
[www.cbre.us/200allegheny](http://www.cbre.us/200allegheny)

Landlord is offering turnkey buildouts with attractive building standard finishes



## Building Highlights

- + Completed extensive capital improvements to include new lobby, upgraded restrooms and common areas, landscaping, parking lot resurfacing
- + Close proximity to abundant retail amenities available in Cranberry Township
- + **Second floor suite available: 10,404 RSF**
- + **Recently completed deal: Allegheny Health Network's Regional Home Health & Hospice, leasing 15,789 RSF (second floor)**
- + 5 parking spaces per 1,000 RSF
- + **100% of commission paid at lease signing**
- + Backup generator

Second Floor: 10,404 RSF Available

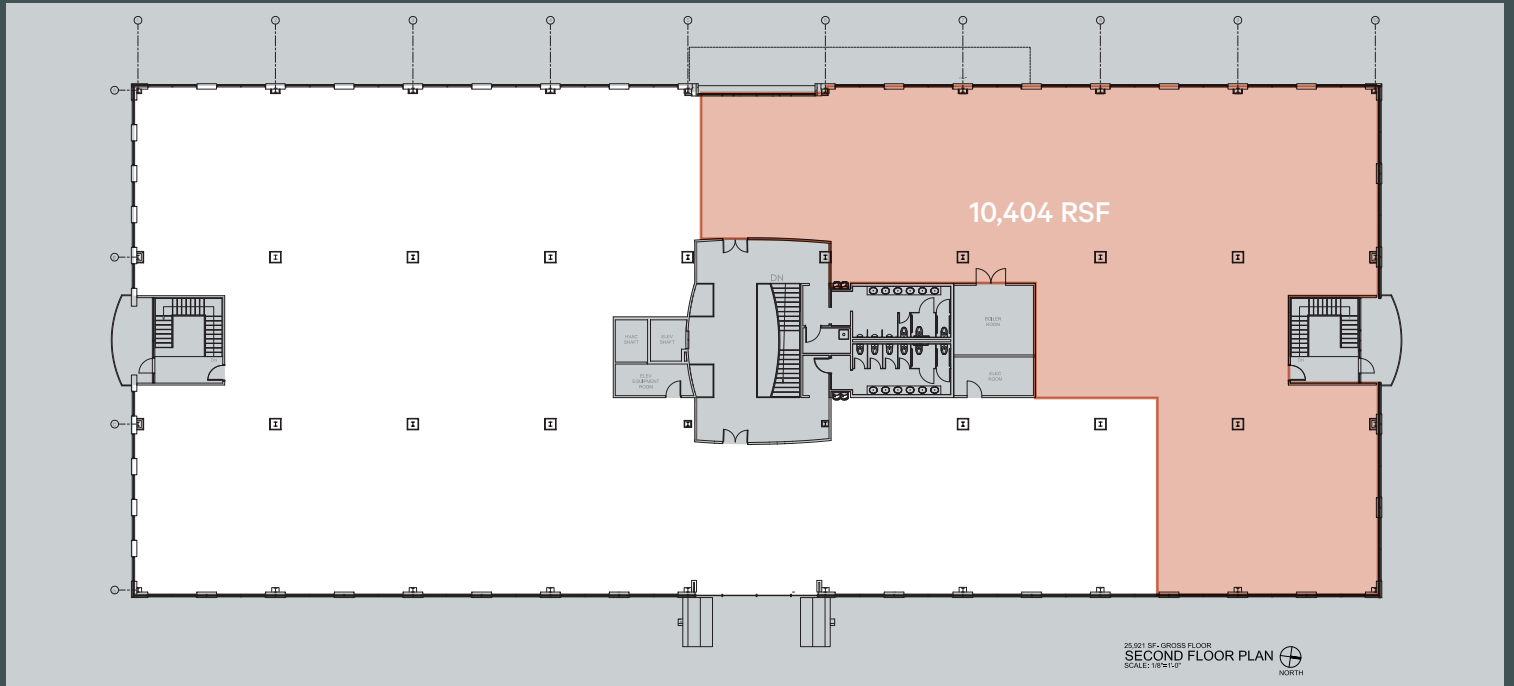

Clockwise from top left: new lobby & atrium, second floor open office – ready for customization, sample reception area, conference room & kitchen

# Last Remaining Office Suite

200 Allegheny Drive | Warrendale, PA 15086

# For Lease

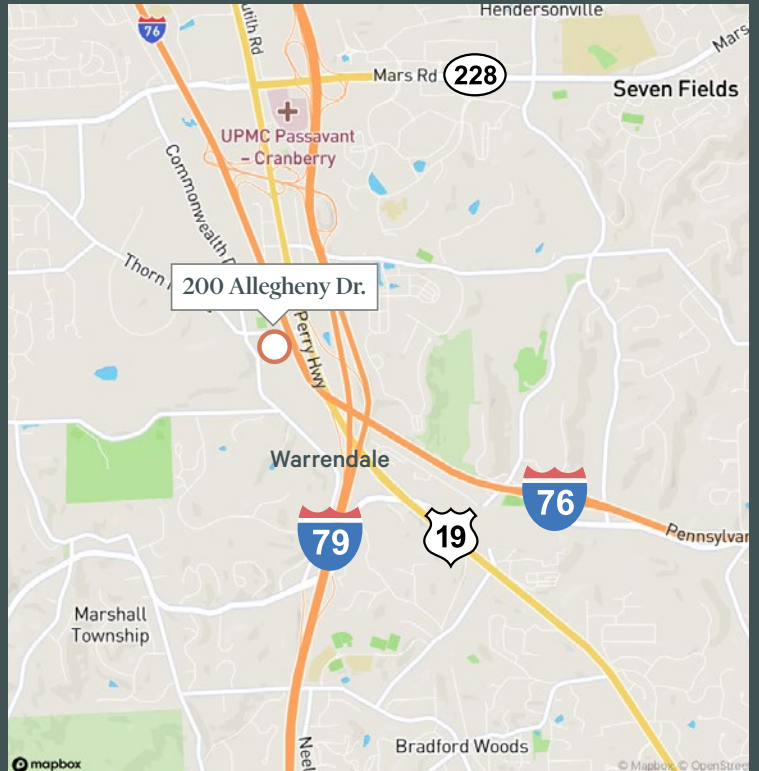

## Contact

**Patrick Greene**

Senior Vice President

+1 412 471 3017

pj.greene@cbre.com

© 2023 CBRE, Inc. All rights reserved. This information has been obtained from sources believed reliable but has not been verified for accuracy or completeness. CBRE, Inc. makes no guarantee, representation or warranty and accepts no responsibility or liability as to the accuracy, completeness, or reliability of the information contained herein. You should conduct a careful, independent investigation of the property and verify all information. Any reliance on this information is solely at your own risk. CBRE and the CBRE logo are service marks of CBRE, Inc. All other marks displayed on this document are the property of their respective owners, and the use of such marks does not imply any affiliation with or endorsement of CBRE. Photos herein are the property of their respective owners. Use of these images without the express written consent of the owner is prohibited.

[www.cbre.us/200allegheny](http://www.cbre.us/200allegheny)

# CBRE