



501

BOYLSTON STREET

BACK BAY RETAIL OPPORTUNITY
BOSTON, MA

CBRE

Property Highlights



501 Boylston Street is located on one of Newbury and Boylston Streets highest trafficked blocks, between Berkeley and Clarendon Streets. The available retail spaces are cotenants with Sephora, Athleta, H&M and Nordstrom Rack, with a surrounding market mix of high-end fashion, cafes, Class A office space and a bustling daytime population.

Within one mile of 501 Boylston Street



RESIDENTIAL
POPULATION

94,606



AVERAGE
HOUSEHOLD INCOME

\$154,346



EMPLOYEE
POPULATION

280,646



NUMBER OF
HOUSEHOLDS

48,824



Retail Market

HUNDREDS OF RETAILERS HAVE EXPERIENCED
TREMENDOUS SALES VOLUMES AND INTERNATIONAL
BRAND EXPOSURE IN BOSTON'S BACK BAY.

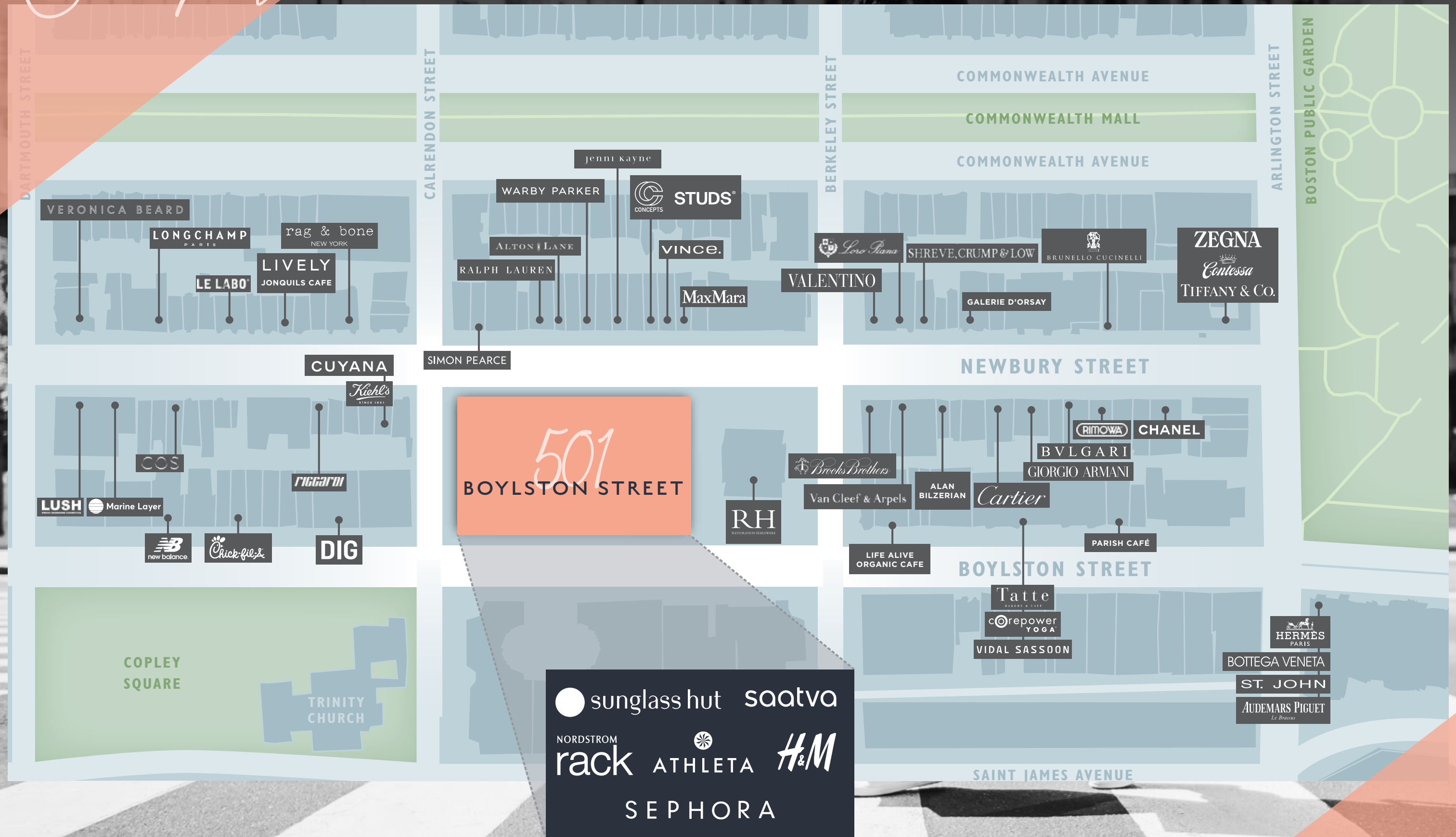

CLARENDON STREET

BOYLSTON STREET

Directly across from popular retailers including Concepts, Jenni Kayne, Max Mara, Vince, Studs and Warby Parker on Newbury Street

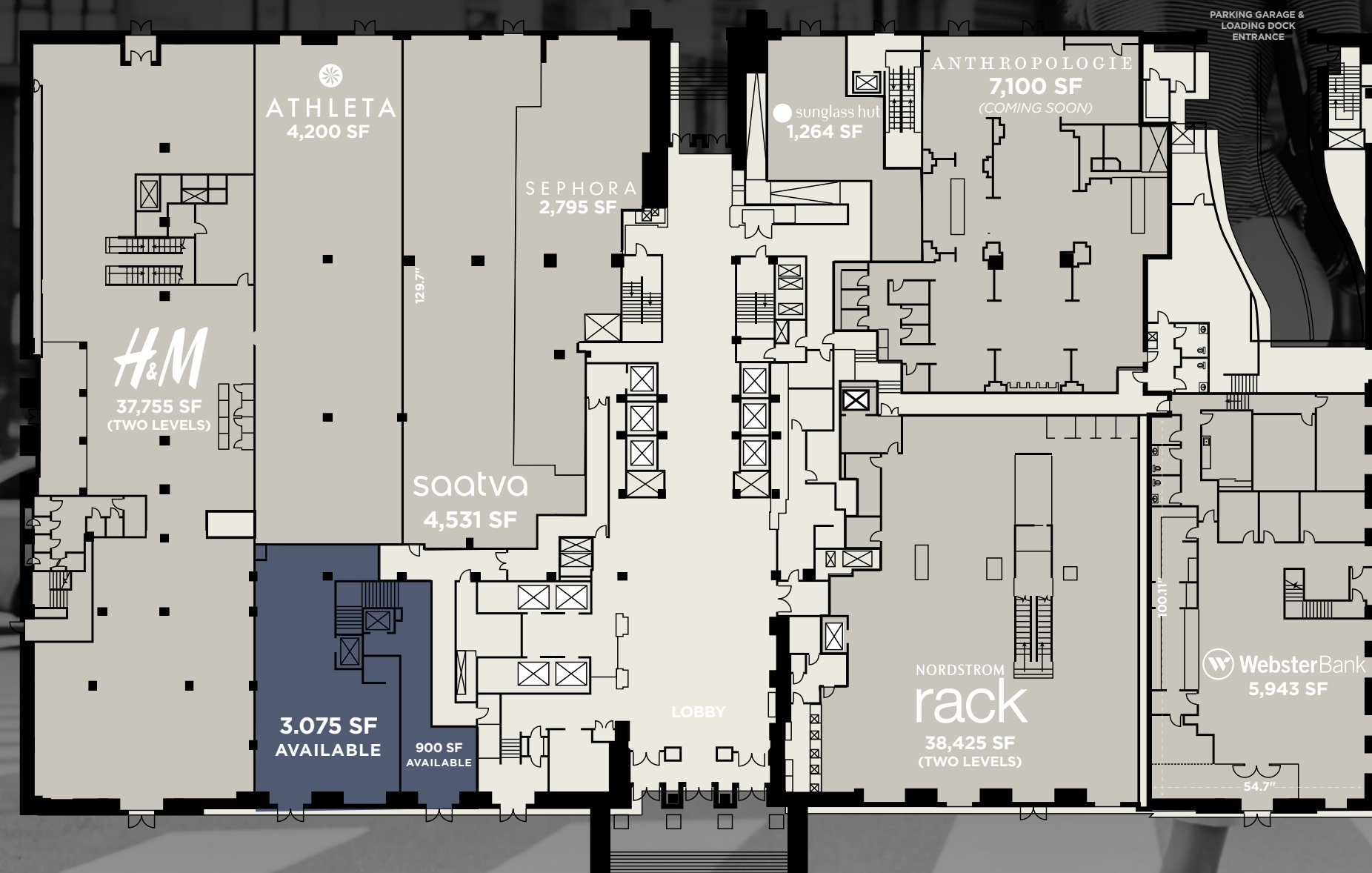

Lower Level Plan

501
BOYLSTON STREET

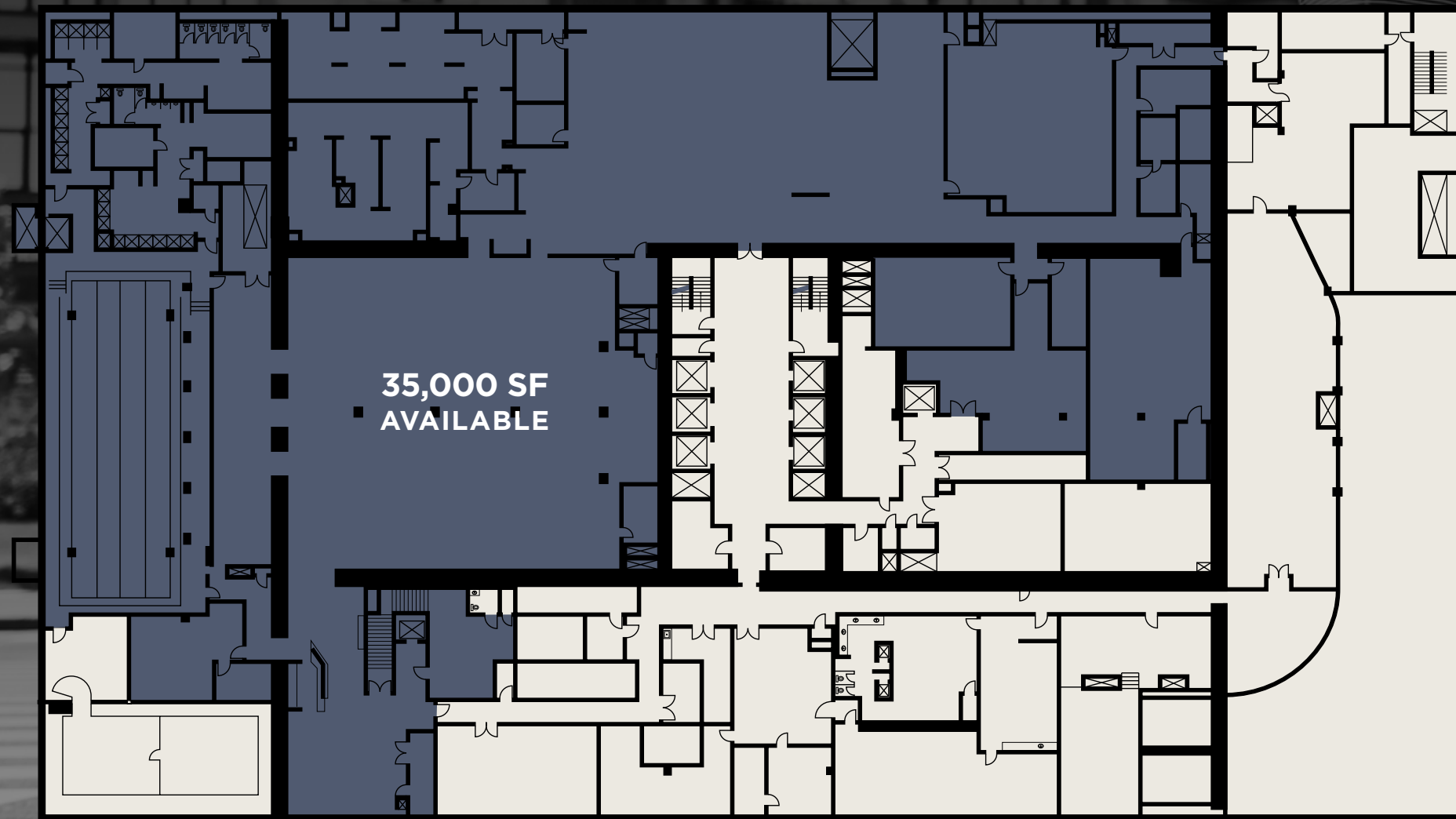



501

BOYLSTON STREET

FOR MORE INFORMATION

MATT CURTIN

Senior Vice President

+1 617 912 6861

matthew.curtin2@cbre.com

GREG COVEY

Senior Vice President

+1 617 912 5204

greg.covey@cbre.com

CBRE**nuveen**
REAL ESTATE

© 2022 CBRE, Inc. All rights reserved. This information has been obtained from sources believed reliable, but has not been verified for accuracy or completeness. You should conduct a careful, independent investigation of the property and verify all information. Any reliance on this information is solely at your own risk.

CBRE and the CBRE logo are service marks of CBRE, Inc. All other marks displayed on this document are the property of their respective owners. Photos herein are the property of their respective owners. Use of these images without the express written consent of the owner is prohibited.