

FOR LEASE

Owned and Operated by  **LINK**

1330 FITZGERALD AVE

San Francisco, CA 94124

±94,304 SF

Transit Adjacent, Industrial/Flex Space



**LEASING INFO
& CONTACT**

Mark Geisreiter	RE LIC 00889721	(415) 290-5797 / mark.geisreiter@nmrk.com
Aaron Gillespie	RE LIC 01971974	(720) 495-7735 / aaron.gillespie@nmrk.com

NEWMARK



BUILDING HIGHLIGHTS

High-End Manufacturing and Warehouse Space

Move-In Ready

Outdoor Space with Sport Court

Adjacent to Third Street Light Rail

Exterior Signage Available

Excellent Access 12 Dock-High Doors; 1 Drive-In Door



BUILDING DESCRIPTION

Year Built:	1952 by Betchel Corporation	Fully Sprinklered
	2nd Floor Renovated in 2015	HVAC: Full HVAC on 2nd Floor
Seismic Upgrade:	1991	Ground: Gas Powered Heaters
Roof Upgrade:	2011	Outdoor Space: Gated Courtyard Along Third St
Electrical Power:	3-Phase, 1600 Amps	Freeway Access: 2 Min Drive to US 101
Ceiling Heights:	<14' Warehouse; 12' Office	Ground Floor: ±79,440 SF
Loading Bays:		Second Floor: ±14,864 SF
Fitzgerald St:	7 Covered Dock-High Roll-Up Doors	Lease Term: 7-10 Years
Egbert St:	5 Dock-High Doors; 1 Roll-Up Door	Zoning: PDR-2
Type of Loading:	Dock-High and Drive-In	

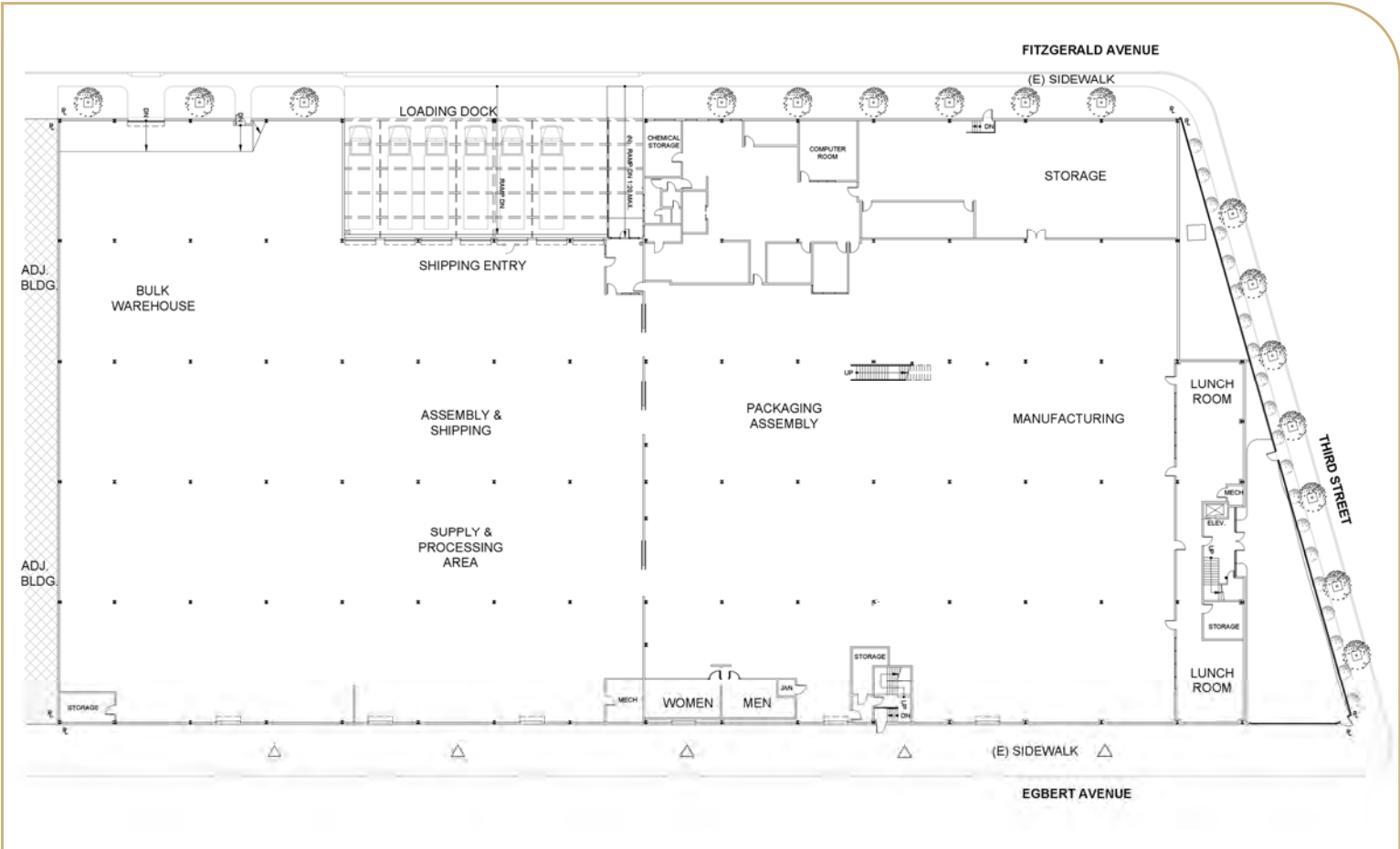

SUITE NOTES

Ground Floor	±79,440 SF
Ceiling Height	14', 9"
Access	5 Dock-High; 1 Roll-Up Door
Power	3-Phase, 1600 Amps

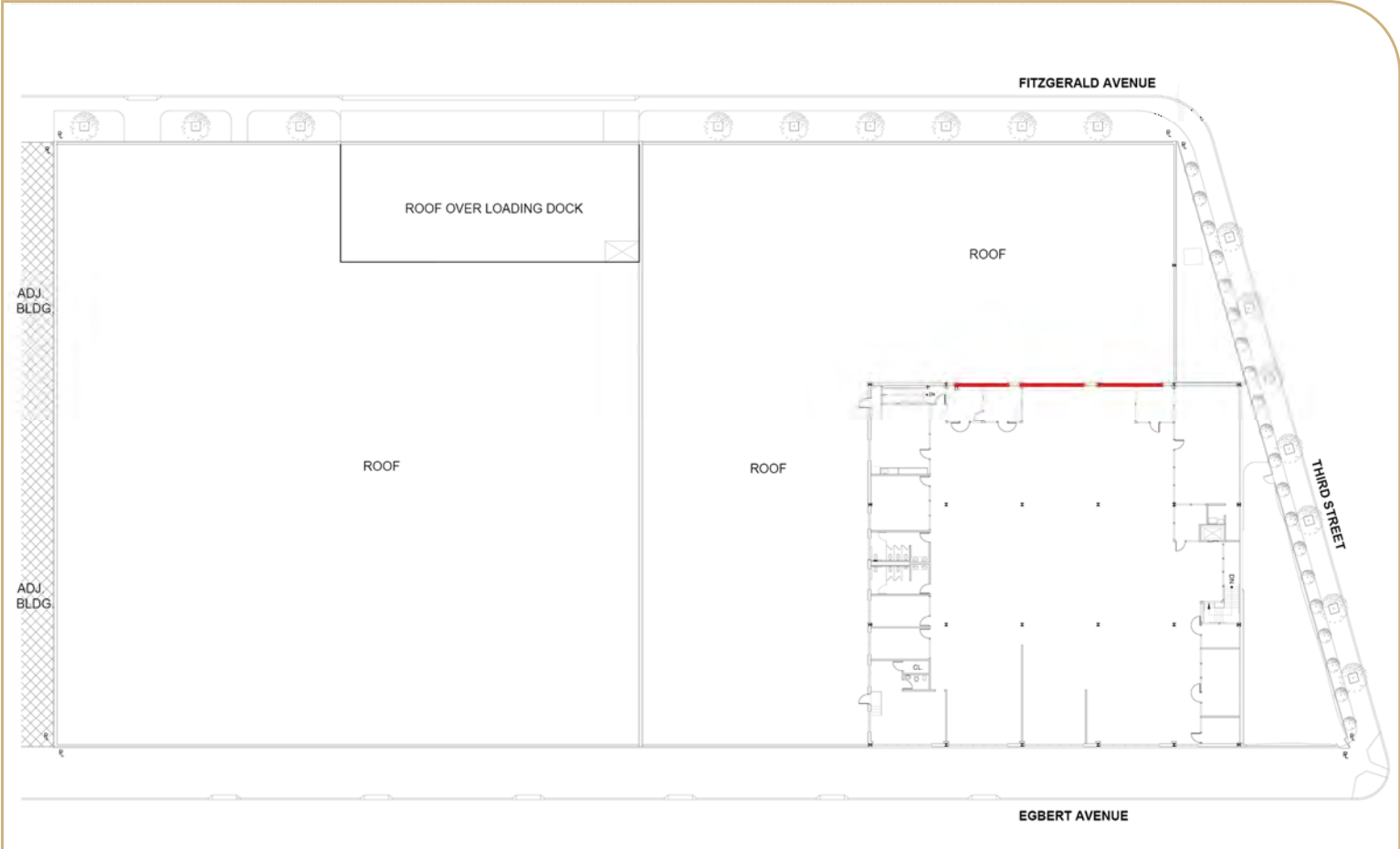

SUITE NOTES

Second Floor	±14,864 SF
Ceiling Height	12'

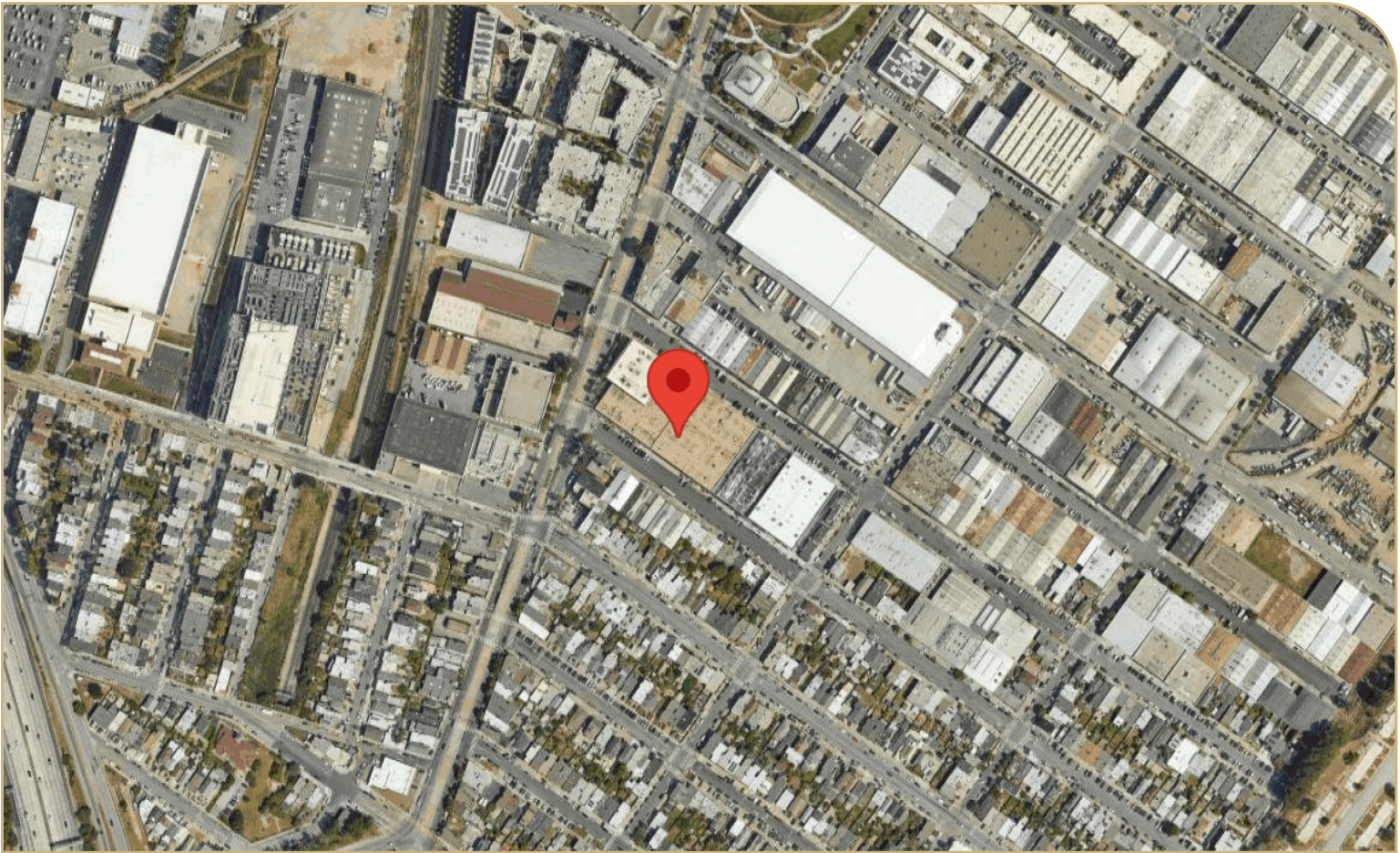

TRANSIT

- Drive

2 Min to US 101
- 4 Min to Caltrain Bayshore Station
- 9 Min to SFO
- 11 Min to Bay Bridge

- Walk

1 Min to Muni Light Rail K/T
- 15 Min to Muni Bus 29

FOR LEASE

Owned and Operated by  **LINK**

1330 FITZGERALD AVE

San Francisco, CA 94124

±94,304 SF

Transit Adjacent, Industrial/Flex Space



**LEASING INFO
& CONTACT**

Mark Geisreiter	RE LIC 00889721	(415) 290-5797 / mark.geisreiter@nmrk.com
Aaron Gillespie	RE LIC 01971974	(720) 495-7735 / aaron.gillespie@nmrk.com

NEWMARK