



CARPENTERS
LOGISTICS CENTER

±752,134 SF FOR SALE OR LEASE

CROSS DOCK (DIVISIBLE)

5-ACRES OF INDUSTRIAL OUTDOOR STORAGE



CONSTRUCTION COMPLETE

15600 Carpenters Logistics Dr.
Channelview, TX 77530

carpenterslogisticscenter.com

CBRE

Trammell Crow Company

PORT OF HOUSTON

- #1 U.S. Port in Waterborne Tonnage
- 8 Public Terminals
- 52 Miles of Inland Waterway

LOCATION

- 0.6 Miles to I-10
- 2.6 Miles to Beltway 8
- 5 Miles to Spur 330
- 8 Miles to Hwy 225

 PORT OF HOUSTON LOCATIONS

 CONTAINER TERMINAL

 GENERAL CARGO



PARK ACCESS



CARPENTERS
LOGISTICS CENTER

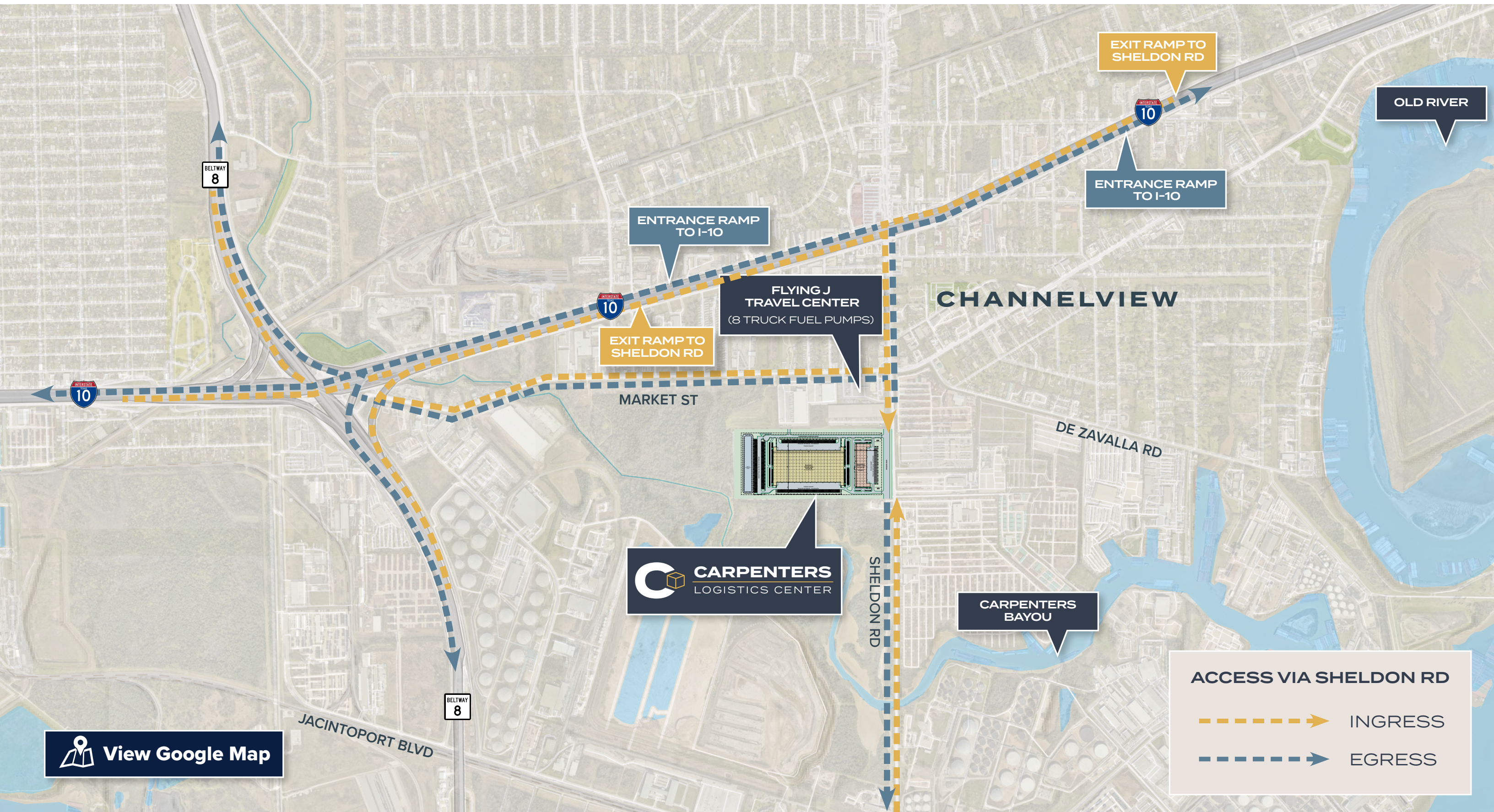

ACCESS VIA SHELDON RD

- INGRESS
- EGRESS

[View Google Map](#)

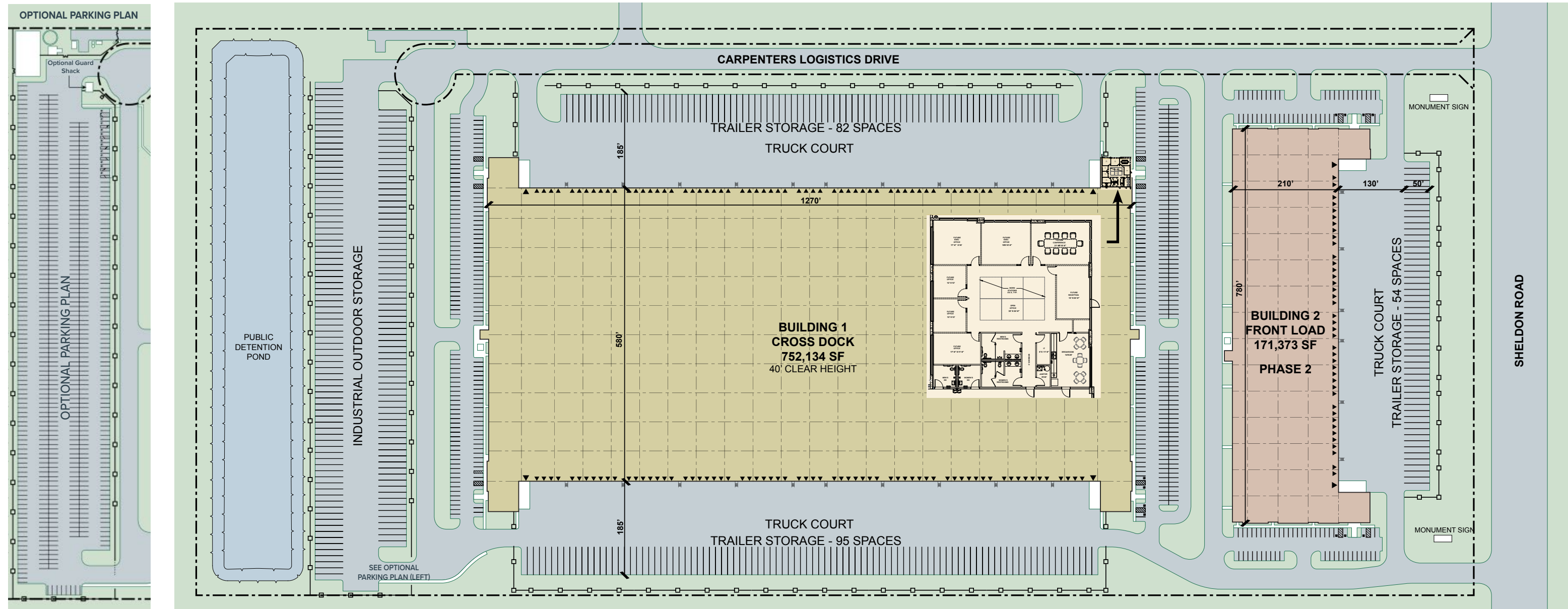

BUILDING 1

- ± 752,134 SF Cross Dock (Divisible)
- Structural Tilt-Wall Construction
- 40' Clear Height
- 56' x 57.5' Typical Column Spacing w/ 60' Speed Bays
- ± 3,600 SF Speculative Office Space
- 388 Car Stalls (Expandable)
- 177 Trailer Stalls
- 8" Reinforced Slab
- Moment Structural Frames
- (4) Drive-In Ramps
- (136) 9'x10' O.H. Doors
- (4) 12'x14' O.H. Doors
- Interior Warehouse Walls Painted White
- ESFR Sprinkler System
- 185' Truck Courts
- LED Lighting
- (2) 1500 kVA Transformers w/ 3610 Amps Combined Capacity (Expandable)
- (2) Electrical Tap Boxes and Wireways Each Rated 4,000 Amps
- 60 Mil TPO Roof

INDUSTRIAL OUTDOOR STORAGE

- 5-Acres of Paved Storage
- Fenced and Gated
- LED Site Lighting
- Additional 153 Trailer Stalls or 595 Car Stalls

AERIAL VIEW



CARPENTERS
LOGISTICS CENTER

HOUSTON SHIP CHANNEL

TEXAS MEDICAL CENTER

GALLERIA

HOUSTON CBD



BELTWAY
8

INTERSTATE
10



SHELDON RD

MARKET ST

AERIAL VIEW



CARPENTERS
LOGISTICS CENTER

JACINTO PORT
TERMINAL

HOUSTON SHIP
CHANNEL

JACINTO PORT BLVD

SHELDON RD



MARKET ST





Trammell Crow Company

Trammell Crow Company, founded in 1948, is one of the nation's leading developers, operators and investors in real estate. The company has developed or acquired over 2,900 properties with a value exceeding \$75 billion. The philosophy of Trammell Crow Company is built upon the commitment of servicing the needs of its customers, employees and communities through a network of local partners who understand the specific dynamics of their local markets.

© 2025 CBRE, Inc. All rights reserved. This information has been obtained from sources believed reliable, but has not been verified for accuracy or completeness. You should conduct a careful, independent investigation of the property and verify all information. Any reliance on this information is solely at your own risk.

CBRE and the CBRE logo are service marks of CBRE, Inc. All other marks displayed on this document are the property of their respective owners. Photos herein are the property of their respective owners. Use of these images without the express written consent of the owner is prohibited.

FOR ADDITIONAL INFORMATION, PLEASE CONTACT:

CAPE BELL

Senior Vice President
713 577 1737
cape.bell@cbre.com

JASON DILLEE

Executive Vice President
713 577 1796
jason.dillee@cbre.com

ANDREW JEWETT SR.

Senior Vice President
713 577 1735
andrew.jewett@cbre.com

KAYLA RIPPLE

Transaction Manager
713 577 1731
kayla.ripple@cbre.com

carpenterslogisticscenter.com



KEY ROUTES

- Carpenters Logistics Center
- Route
- Destination
- Port of Houston Locations

1. Jacintoport (2.6 mi.)
2. Houston CBD (12 mi.)
3. Barbour's Cut Terminal (18 mi.)
4. William P Hobby Airport (19 mi.)
5. Bayport Terminal (21 mi.)
6. Bush Intercontinental Airport (24 mi.)

